

This cover section is produced by the AIA Archives to show information from the online submission form. It is not part of the pdf submission upload.

## 2025 AIA Fellowship

Candidate Suzanne Riley Klein  
Organization AECOM  
Location Arlington, Virginia  
Chapter AIA Washington DC;

### Category of Nomination

Object 2 (Practice Management, Technical Advancement) > Practice (Technical Advancement)

### Summary Statement

Suzanne Klein's collegiate projects harness the power of architecture to propel engaged learning, belonging, and community building. Leveraging expertise and collaborative methodologies, she transforms campus typologies, drives design excellence, and inspires generations of professionals.

### Education

University of Michigan: 9/1988-5/1990, Master of Architecture  
University of Virginia: 6/1983-5/1985, Bachelor of Science, Architecture  
University of Delaware: 9/1981-5/1983, no degree

### Licensed in:

Maryland  
Virginia

### Employment

Education Practice Leader, Principal: AECOM, Arlington, VA (7/2020 – present)  
Project Executive & Senior Project Director, Principal: EYP, Washington, DC (8/2011 – 6/2020)  
Project Manager: Kling Stubbins, Washington, DC (3/2010 – 8/2011)  
Education Practice Leader, Studio Director, and Project Manager: Gensler, Washington, DC (6/2006 – 2/2010)  
Project Manager, Project Architect: Allan Greenberg, Architect, Washington, DC (8/1995 – 6/2006)  
Project Architect: Hartman-Cox Architects, Washington, DC (2/1994 – 8/1995)  
Project Architect: Oudens + Knoop Architects, Bethesda, MD (2/1993 – 2/1994)  
Job Captain, Designer: Allan Greenberg, Architect, Washington, DC (5/1990 – 2/1993)  
Teaching Assistant: University of Michigan, Ann Arbor, MI (9/1989-5/1990)  
Job Captain/Designer: Garrison Associates Architects, Vienna, VA (9/1985 – 9/1988)

7 October 2024

Carl D'Silva, FAIA, AIA  
2025 Chair, Jury of Fellows, American Institute of Architects  
1735 New York Ave NW  
Washington, DC 20006

Re: Sponsorship of Suzanne R. Klein, AIA  
Elevation to Fellowship

Dear Chair D'Silva and Members of the Jury of Fellows:

I am pleased and honored to sponsor **Suzanne R. Klein, AIA**, for elevation to the College of Fellows of the American Institute of Architects. I met Suzanne in 1983 when we were undergraduates in the School of Architecture at the University of Virginia. Our paths crossed again when she joined Hartman-Cox Architects in 1994. Over these intervening years, I have had the privilege of observing her remarkable contributions to the profession and campus life at universities and colleges across the country and beyond. Suzanne is an exceptional architect, and her contributions should be recognized with Fellowship in the American Institute of Architects under *Object 2 – Practice Technical Advancement*.

While I could elaborate on many facets of Suzanne's career and her commitment to creating collegiate projects that matter, I will focus on just a few. Suzanne is a subject matter expert who advances the profession with her technical expertise, fostering an evolution in educational space typologies that drives design excellence and creates positive impacts on student outcomes and experiences. She propels mission-driven clients to optimize their facilities to promote enhanced learning outcomes and campus legacies. Her projects have been recognized with numerous awards by the AIA and other allied organizations. Along the way Suzanne is sharing her methodology and impacting our profession by educating and mentoring her team members for lifelong success and leadership.

To share the knowledge gained over the past 35 years of practice, Suzanne regularly speaks at *Society for College and University Planning* conferences. Through these presentations, Suzanne furthers AIA Values and the AIA Framework for Design Excellence by sharing case studies which focus on the design for equitable communities, sustainability, and well-being. Suzanne is a regular lecturer and juror at numerous universities. Within the community, Suzanne has served as a Planning Commissioner for Arlington County, Virginia where she was often the only architect as well as Chairing the Historical Affairs and Landmarks Review Board of the same. At the University of Virginia School of Architecture, Suzanne serves on the Spaces Committee where her expertise gives back to our alma mater supporting the next generation of architects and planners.

Suzanne Klein is instrumental in the creation of complex, transformative planning, and enduring design solutions because she understands the unique requirements of colleges and universities from the smallest details to the planning of entirely new campuses. Not only has her work enhanced campuses from coast to coast, but her contributions to the broader community have a positive impact on the technical advancement of the science and art of architecture. I heartily endorse Suzanne's advancement to the College of Fellows.

Sincerely,



Mary Katherine Lanzillotta, FAIA  
Chair, College of Fellows Jury, 2017

**Suzanne Klein's collegiate projects harness the power of architecture to propel engaged learning, belonging, and community building. Leveraging expertise and collaborative methodologies, she transforms campus typologies, drives design excellence, and inspires generations of professionals.**

### TRANSFORMING CAMPUS TYPOLOGIES TO FOSTER LEARNING AND INCLUSIVITY

Suzanne transforms collegiate typologies — academic, science, wellness, and athletic facilities, residence halls, and campus plans — to expand innovative pedagogical models, propel interdisciplinary learning, and foster inclusivity.

At the start of Suzanne's career, collegiate instruction was primarily lecture-based, siloed by department, and in windowless spaces. By implementing design principles that promote academic success, she creates adaptable, dynamic spaces that seamlessly integrate technology, flexible infrastructure, and incorporate daylight.

At the University of Delaware's Gore Hall, Suzanne advanced the classroom building typology to support instructional practices that promote learning and collaboration. **Gore Hall serves 24,000+ students yearly and remains the university's most popular building. This seminal structure laid the foundation for Suzanne's subsequent collegiate projects** — each building upon the success of its predecessors.

By integrating disparate programs across campus into one holistic facility, Suzanne evolved the wellness building typology at the College of William & Mary. **The McLeod Tyler Wellness Center's director cites Suzanne's expertise for improving the well-being of 9,600+ students.** The award-winning project has become a wellness center paradigm with leaders from other campuses visiting the building to learn from this innovative typology.

Inspired by the life-changing impact of collegiate design, **she has completed 100+ projects on 45+ campuses across the globe.**

### DRIVING DESIGN EXCELLENCE TO ENRICH THE STUDENT AND COMMUNITY EXPERIENCE

Suzanne empowers stakeholders to expand their design vision to promote thriving cultures. Her leadership creates places that **enrich the student life experience, enhance belonging, and build community for hundreds of thousands of students, faculty, staff, and visitors.**

Suzanne's bespoke methodologies seamlessly integrate qualitative and quantitative data to promote design excellence, enhance the campus experience, and elevate each typology's opportunities in each unique project.

To develop China's first independent global college campus, Duke Kunshan University, Suzanne established planning metrics through strategic benchmarking. **Her expertise directly contributed to the success of the new campus and AIA award-winning buildings.**

At George Washington University, Suzanne established a more inspirational vision through a collaborative stakeholder engagement process. The re-imagined project turned an outdated building into a dynamic recruiting tool — **improving the student athlete experience and creating a facility used by the entire campus community.**

In Arlington, Virginia, Suzanne spearheaded the creation of Arlington's first preservation plan and launched the county's inaugural design awards program, **fostering a greater appreciation for architecture and preservation.** Through her extensive volunteer leadership, her efforts continue to advance design excellence and promote sustainability for residences, institutional and commercial structures, and public places.

### INSPIRING GENERATIONS OF PROFESSIONALS AND ADVANCING THOUGHT LEADERSHIP

As a thought leader and mentor, **Suzanne shares expertise with colleagues, emerging professionals, and students.** Having served in leadership roles at multiple firms, she now leads AECOM's Education Practice and collaborates with global colleagues to advance the profession.

Throughout her career, Suzanne has mentored and trained staff in collegiate design, fostering their professional growth. Her mentees, numbering in the hundreds, are vital contributors to projects. Today, **many hold leadership positions nationwide and credit her dedication to empowering women in the profession.**

At numerous architecture schools, **Suzanne's valuable insights empower future architects** in her roles as a juror, panelist, lecturer, thesis critic, competition judge, studio reviewer, and potential employer.

Suzanne's influence is demonstrated by 20+ years with the Society of College and University Planning, the preeminent international organization dedicated to advancing collegiate planning and design. **She speaks at conferences nationwide, engaging hundreds of professionals** on topics that drive academic design and planning.

She also writes thought leadership articles and blogs, sharing insights that influence design in higher education. **Suzanne's work reaches tens of thousands of design and management professionals.**



## EDUCATION

**University of Michigan:** Master of Architecture with High Distinction, 1990

**University of Virginia:** Bachelor of Science, Architecture, 1985

## REGISTERED ARCHITECT

**Maryland:** 2009

**Virginia:** 1992

## CERTIFICATIONS

**WELL AP:** July 2021

**LEED AP:** December 2006

## EMPLOYMENT

**Education Practice Leader, Principal:** AECOM, Arlington, VA (2020-present)

**Project Executive & Senior Project Director, Principal:** EYP, Washington, DC (2011-2020)

**Project Manager:** KlingStubbins, Washington, DC (2010-2011)

**Education Practice Leader, Studio Director, & Project Manager:** Gensler, Washington, DC (2006-2010)

**Project Manager & Project Architect:** Allan Greenberg, Architect, Washington, DC (1995-2006)

**Project Architect:** Hartman-Cox Architects, Washington, DC (1994-1995)

**Project Architect:** Oudens + Knoop Architects, Bethesda, MD (1993-1994)

**Job Captain & Designer:** Allan Greenberg, Architect, Washington, DC (1990-1993)

**Job Captain & Designer:** Garrison Associates Architects, Vienna, VA (1985-1988)

## PROFESSIONAL AFFILIATIONS

**National Council of Architectural Registration Boards (NCARB)** (certification in progress)

**International WELL Building Institute** (2021-present)

**Society of College and University Planning** (2020-present, 2001-2018)

**NCARB, AXP Supervisor & Mentor** (2015-2017)

**American Institute of Architects** (1992-present)

## CORPORATE LEADERSHIP

**AECOM Global Higher Education Leadership** (2021-present)

**AECOM East Region Senior Leadership** (2020-present)



Suzanne deeply understands academic cultures, STEM fields, and the types of pedagogical and scholarly spaces that are both needed at the moment and will stand the test of time. Through iterative conversations, she listened carefully to our wants and needs, and she masterfully helped us envision the possible while simultaneously building trust and developing a new mindset among our faculty."

- **Dr. Jeffrey M. Osborn**, Provost and Vice President for Academic Affairs, The College of New Jersey

See Exhibit 3.4



**Suzanne's work across 45+ campuses spans numerous collegiate typologies. Her expertise integrates innovative pedagogies, technical criteria, and sustainable strategies, fostering meaningful experiences for thousands of students, faculty, staff, and visitors.**

**American University**, Washington, DC  
**Berea College**, Berea, KY  
**Capitol College**, Laurel, MD  
**Catholic University of America**, Washington, DC  
**Clemson University**, Clemson, SC  
**College of William & Mary**, Williamsburg, VA  
**College of Wooster**, Wooster, OH  
**Duke Fuqua School of Business**, India  
**Duke Kunshan University**, Kunshan, China  
**Duke University**, Durham, NC  
**Florida International University**, Miami, FL  
**Gallaudet University**, Washington, DC  
**George Mason University**, Arlington, Fairfax, and Manassas, VA  
**George Washington University**, Washington, DC  
**Georgia Tech**, Atlanta, GA  
**Harvard-Smithsonian Astrophysical Observatory**, Cambridge, MA, Tucson, AZ, and Hilo, HI  
**James Madison University**, Harrisonburg, VA  
**Loyola Marymount University**, Los Angeles, CA  
**Lynn University**, Boca Raton, FL  
**Middlesex College**, Edison, NJ

**National Defense University**, Washington, DC and Norfolk, VA  
**Pennsylvania State University**, State College, PA  
**Prince George's Community College**, Largo, MD  
**Princeton University**, Princeton, NJ  
**Randolph College**, Lynchburg, VA  
**Rice University**, Houston, TX  
**St. John's University**, Queens, NY  
**Swarthmore College**, Swarthmore, PA  
**The College of New Jersey**, Ewing, NJ  
**University of Connecticut**, Storrs, CT  
**University of Delaware**, Newark, DE  
**University of Maryland**, College Park, MD  
**University of Miami**, Coral Gables, FL  
**University of Pennsylvania**, Philadelphia, PA  
**University of Virginia**, Charlottesville, VA  
**Virginia Commonwealth University**, Richmond, VA  
**Virginia Tech**, Blacksburg, Virginia Beach, and Roanoke, VA  
**Virginia Union University**, Richmond, VA  
**Washington & Lee University**, Lexington, VA  
**Washington College**, Chestertown, MD

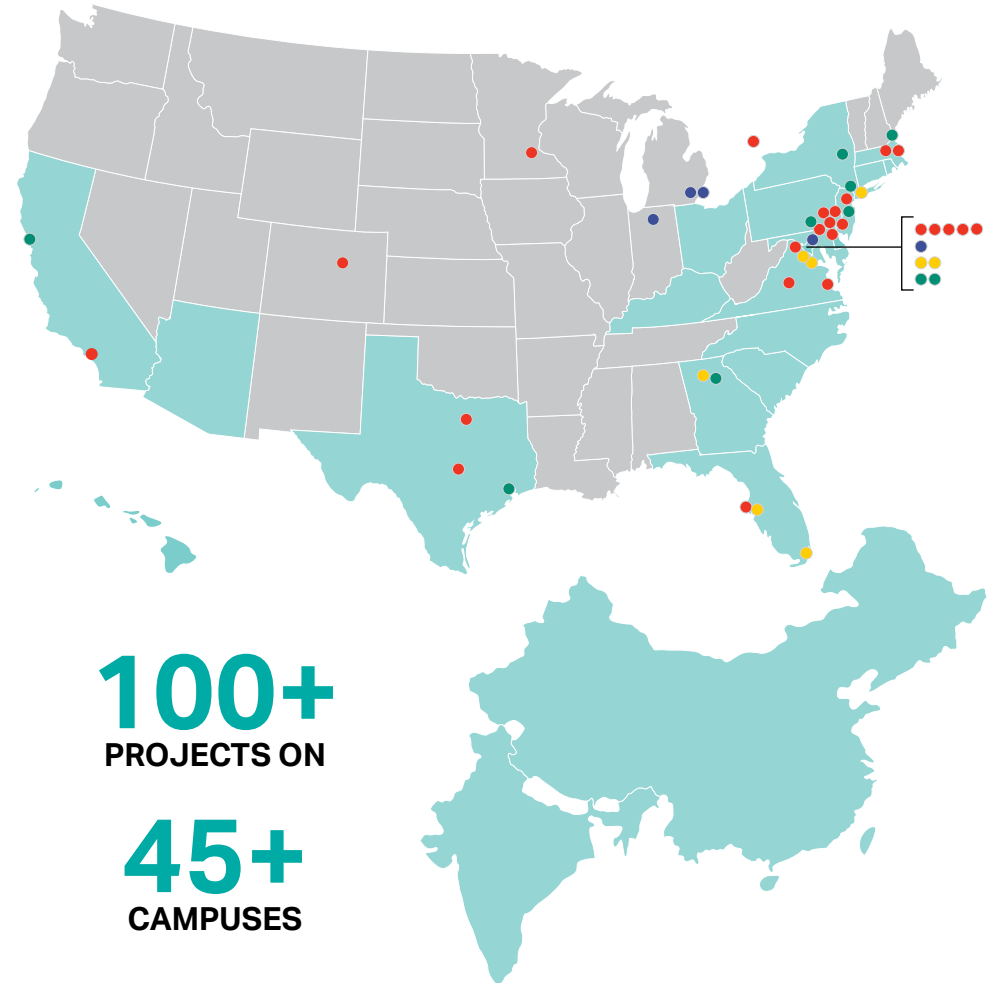

**100+**  
PROJECTS ON  
**45+**  
CAMPUSES

“

With her depth of knowledge and leadership, Suzanne is an exceptional, collaborative, and inspiring leader. Her ability to work across geographies, share expertise, and to advance the practice in higher education planning and design is extremely impressive.”

- Sean Chiao, FAIA, Group CEO Surbana Jurong Group, Singapore

#### Legend

- Project Locations by State/Country
- Speaking Engagements & Conferences
- Academic Service
- Emerging Leaders Featured in Exhibit 3.10
- References

Suzanne advances planning and design to elevate the student life experience. She incorporates principles of well-being, equitable communities, and integration throughout each project to promote a sense of belonging and empower students to thrive.



#### McDowell Hall Renovation

**American University**, Washington, DC  
2024 | AECOM | Principal in Charge

Suzanne directed and mentored a team through the extensive renovation of a 1960s-era residence hall, **transforming student life with a variety of collaborative spaces and gender-neutral facilities** designed to foster belonging, promote well-being, and enhance student outcomes.



#### Gibbons House

**University of Virginia**, Charlottesville, VA  
2015 | EYP | Senior Project Director

Suzanne's pivotal leadership **established a new benchmark for residence halls at UVA**. Her innovative concepts in this LEED Gold facility enhance well-being, promote equitable communities, and elevate the student experience by fostering community among first-year students.

*Exhibit 3.7*



#### McLeod Tyler Wellness Center

**College of William & Mary**, Williamsburg, VA  
2018 | EYP | Senior Project Director

Suzanne's innovative leadership in creating this holistic wellness typology transforms student health and quality of life. **This award-winning LEED Gold facility** integrates clinical, counseling, and recreational spaces, **significantly reducing stigma around seeking help and enhancing the well-being of over 9,600 students**.

*Exhibit 3.2*



#### The Mason Inn

**George Mason University**, Fairfax, VA  
2010 | Gensler | Project Manager & Education Practice Leader

Mentoring a novice team, **Suzanne pioneered the development of this atypical campus typology** – the first hotel for a public university in Virginia and the state's first hotel to achieve LEED Gold.



#### Robinson Residence Hall

**Penn State University**, State College, PA  
2017 | EYP | Senior Project Director

For this design-build project, Suzanne developed solutions that enhance student life and well-being. **Key collaborative and support spaces foster community and advance campus-wide gender-neutral initiatives** within this 300-bed, LEED Silver residence hall.



#### The D'Angelo Center

**St. John's University**, Queens, NY  
2009 | Gensler | Education Practice Leader

This project, influenced by Suzanne's work on the Humanities Building at Rice University, revitalizes St. John's original design vernacular. Centrally located, **the D'Angelo Center is the flagship student center with a diverse variety of spaces to support academics and auxiliary programs for 20,000+ students**.



Suzanne's transformative academic buildings create a lasting impact for students and faculty with designs that promote pedagogical methodologies and engaged learning. Through her projects, she advances the collegiate mission and enriches campus architectural legacy.



#### Johnston Hall

**James Madison University**, Harrisonburg, VA  
Ongoing | AECOM | Principal in Charge

Suzanne is leading the renovation of and addition to a historic campus building by adding a new main entry, vital classrooms, offices, and collaborative spaces that will **transform academic departments and enhance facilities for undergraduates, graduate students, and faculty.**



#### Cromwell Hall Academic Building

**Washington College**, Chestertown, MD  
2016 | EYP | Senior Project Director

Suzanne oversaw the creation of this award-winning building designed to LEED Gold standards. The building **features distinctive teaching and research spaces**, such as an outdoor classroom and garden, and supports environmental and other academic programs while seamlessly integrating with its historic neighborhood.



#### Aaron Burr Hall

**Princeton University**, Princeton, NJ  
2006 | Allan Greenberg, Architect – Design Architect; KSS Architects – Architect of Record | Project Architect

Suzanne led the programming and design for this renovation of and addition to an endangered circa-1885 Richard Morris Hunt structure. The project **extended the legacy of this prominent building, provided critical space for academic programs**, and won a preservation design award from the Historical Society of Princeton.



#### The Humanities Building

**Rice University**, Houston, TX  
2000 | Allan Greenberg, Architect – Design Architect & Architect of Record; Morris Architects – Local Consultant | Project Architect

Suzanne spearheaded the planning and detailing of this iconic building, setting a new standard for campus architecture by elevating the humanities community, advancing Rice's innovative architectural style, and serving as a model for future structures.

*Exhibit 3.9*



#### Gore Hall

**University of Delaware**, Newark, DE  
1998 | Allan Greenberg, Architect | Project Architect

This project changed the trajectory of Suzanne's career, igniting her passion for collegiate design and influencing every subsequent project. As one of the university's legacy structures, Gore Hall remains its most scheduled academic learning venue.

*Exhibit 3.8*



Suzanne understands and appreciates the value of strong drawing/specification coordination. The success of unique features, such as the monumental turned concrete columns on Delaware's Gore Hall and the Rice University Humanities Building's brick jointing following the vernacular established by Ralph Adams Cram, are a testament to Suzanne's attention to detail."

- David Metzger, FAIA, FCSI, Heller & Metzger, specifications consultant for Gore Hall and the Humanities Building

Suzanne guides stakeholders through complex STEM projects to create environments that promote collaboration, enhance learning, and advance research – essential elements that encourage discovery and innovation to profoundly impact communities and the global future.



#### E.A. Fernandez IDEA Factory

**University of Maryland**, College Park, MD  
2021 | EYP | Senior Project Director

Under Suzanne's leadership, the project achieved the namesake donor's aspirational vision for the singular building program. The concept resulted in unique thinking, making, and modeling spaces where **students conceive ideas and develop products that spur local and global economic development.**

*Exhibit 3.3*



#### Ruth W. Williams Hall of Life Sciences

**College of Wooster**, Wooster, OH  
2018 | EYP | Senior Project Director

Suzanne oversaw the planning and design of this innovative, interdisciplinary, LEED Silver life science facility that **expands opportunities for mentored undergraduate research and student-faculty collaboration.** Her leadership and technical expertise created a vibrant campus heart for 2,000+ students and 175 faculty which helped elevate the college's rankings.



#### STEM Complex Phases 1, 2, & 3

**The College of New Jersey**, Ewing, NJ  
2017 (Phase 1), 2019 (Phase 2), 2020 (Phase 3) |  
EYP | Senior Project Director

Suzanne led this multi-phase project **completely transforming the campus's STEM facilities and growing innovative science and engineering programs**, while also participating in the state's Smart Start Buildings program to reduce energy usage.

*Exhibit 3.5*



#### Integrated Science Center Phase 3

**College of William & Mary**, Williamsburg, VA  
2016 | EYP | Senior Project Director

Suzanne led the planning and design of this contextual yet innovative LEED Gold structure. The building houses critical teaching and collaborative spaces that **foster multidisciplinary learning and expand research programs to enrich the undergraduate experience.**



#### Life Sciences and Engineering Building

**George Mason University**, Manassas, VA  
2020 | EYP | Senior Project Director

Orchestrating extensive stakeholder engagement, Suzanne led the development of this specialized, adaptable project. By prioritizing purpose-driven scheduling and integrating diverse multidisciplinary programs, **the design fosters unprecedented collaboration and enhances academic growth** while supporting innovative graduate programs in science, technology, engineering, and health.



#### Du Pont Hall

**University of Delaware**, Newark, DE  
2002 | Allan Greenberg, Architect | Project Architect

Building on the success of Gore Hall, Suzanne played a key role in planning that secured a \$20-million seed donation. The details and specifications she crafted for Gore Hall were adapted to **enhance the campus design vernacular and expand essential facilities** for the College of Engineering.



**Suzanne drives integrated and aspirational planning that empowers stakeholders to fulfill their academic missions, expand community outreach, improve student outcomes, and develop sustainable, resilient campuses.**



#### Facilities Master Plan and Three Campus Model

**Prince George's Community College**, Largo, MD  
Ongoing | AECOM | Principal in Charge

Suzanne is leading the reimagining of PGCC's Largo campus while exploring the creation of two new full-service campuses to provide **better access for underserved populations** and serve a wider range of the county's 911,000 residents.



#### Master Plan and Phase 1 Buildings

**Middlesex College**, Edison, NJ  
Ongoing | AECOM | Education Practice Leader

Mentoring a diverse team, Suzanne spearheaded an innovative campus plan that aligns with the county's economic growth and community connectivity goals. Her visionary approach benefits over 10,000 students and 860,000 residents, **transforming the college into a state-of-the-art destination and heart of the community.**

*Exhibit 3.6*



#### West Campus Framework Plan

**George Mason University**, Fairfax, VA  
2018 | EYP | Senior Project Director

To attract and better support the campus population and neighboring communities, Suzanne orchestrated the development of **a visionary plan for a mixed-use district, envisioning a university town center** for 10,000 full-time equivalent students, faculty, and staff.



#### Master Plan and Phase 1 Buildings

**Duke Kunshan University**, Kunshan, China  
2010 (Master Plan), 2014 (Phase 1 Buildings) | Gensler | Education Practice Leader & Project Manager

Suzanne's strategic benchmarking, which integrated Duke's academic standards with China's high expectations, **resulted in the metrics and design principles to establish the first independent global college and LEED-certified campus in China.**

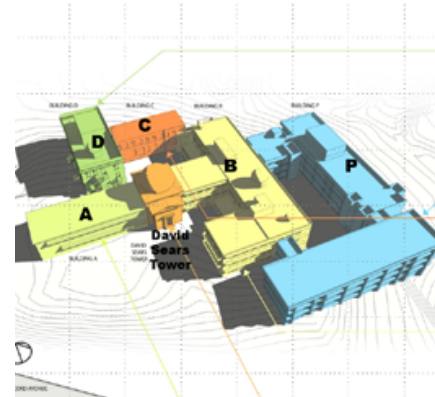

#### Comprehensive Facilities Master Plan

**Harvard-Smithsonian Astrophysical Observatory**, Cambridge, MA; Tucson, AZ; and Hilo, HI  
2011 | KlingStubbins | Project Manager

Suzanne led the assessment and planning to **provide better long-term strategies and optimize utilization** for the largest and most diverse astrophysical institution in the world.



#### Campus Master Plan

**Lynn University**, Boca Raton, FL  
2009 | Gensler | Education Practice Leader

Suzanne directed the development of a comprehensive campus plan that **optimizes land use and creates a more energy-efficient and sustainable ecosystem while reinforcing academic programs** to improve outcomes for 3,500 students.

Suzanne's projects, both large and small, encompass unique typologies that enhance academics, research, and athletics. She focuses each endeavor on achieving design excellence to foster collegiate success, promote inclusivity, and enrich campus culture.



#### Numerous Projects

**Virginia Tech**, Blacksburg, Virginia Beach, and Roanoke, VA  
Ongoing | AECOM | Principal in Charge

Suzanne's forward-thinking leadership and broad expertise span a diverse range of planning and design projects that **significantly influence research, including agricultural research, academic, and laboratory facilities** across Virginia Tech's campuses, serving over 36,000 students.



**Congressional Defense Committee Report**  
**National Defense University**, Washington, DC and Norfolk, VA  
2024 | AECOM | Education Facilities Subject Matter Expert

To secure crucial congressional funding and advance NDU's educational mission, Suzanne delivered a detailed evaluation of and recommendations for campus academic spaces, **aiming to elevate facilities to the highest standards for the next 20+ years.**



#### Multi-Building Renovation

**Clemson University**, Clemson, SC  
2023 | AECOM | Principal in Charge

Suzanne guided the client through this unique project – preparing bridging documents for a complex, 12-building, multi-phased design-build renovation. Under her leadership, **capital investments were maximized and operational impacts were minimized** for some of Clemson's most iconic and highly utilized facilities.



#### Numerous Projects

**George Mason University**, Arlington, Fairfax, and Manassas, VA  
2020 | EYP | Senior Project Director

Suzanne's visionary leadership on diverse projects has **transformed academic spaces, research facilities, and groundbreaking structures**, including the 345,000-square-foot Fuse at Mason Square, which will serve as a hub for innovation.



#### Charles E. Smith Center

**George Washington University**, Washington, DC  
2011 | Gensler | Project Manager & Education Practice Leader

Suzanne developed the strategy that transformed the outdated facility. The renovated LEED Gold building **increases alumni patronage and provides an exceptional student-athlete and community experience.**

*Exhibit 3.4*

“

Beyond Suzanne's technical expertise, what truly set her apart was her ability to inspire and bring together the entire team. Her leadership style was empowering, encouraging everyone to contribute their unique perspectives and ideas. She fostered a collaborative and creative environment which resulted in groundbreaking solutions that surpassed our wildest expectations.”

– **Jason McGhee**, former Assistant Athletic Director, George Washington University



**As a longtime AIA member, Suzanne enhances its influence through her active involvement in the Society of College and University Planning, the preeminent international organization dedicated to advancing integrated planning in higher education.**

## AMERICAN INSTITUTE OF ARCHITECTS (AIA)

**Steering Committee:** AIA | DC Committee on Architecture for Education (AIA | DC CAE) (2023-present)

**Presenter:** "Campus Master Planning as a Catalyst for Broader Community Impact," AIA | DC CAE, Back to School Fall Social, Washington, DC (2023)

**Member:** AIA | DC CAE (2014-present)

**Presenter:** AIA | DC Webinar (2020)

**Attendee:** AIA Women's Leadership Summit (2019)

**Member:** American Institute of Architects (1992-present)

**Member:** AIA Northern Virginia Chapter, Associates Steering Committee (1989-1990)

**Associate Member:** AIA (1985-1992)

## SOCIETY OF COLLEGE AND UNIVERSITY PLANNING (SCUP)

**Member:** 2020-present and 2001-2018

**Presenter:**

- Annual Conference: Philadelphia, PA (2024)
- Mid-Atlantic Conferences: Fairfax, VA (2024); Philadelphia, PA (2023); Baltimore, MD (2010); Washington, DC (2003); Newark, DE (2001)
- Southern Regional Conference: Tampa, FL (2023)

**Conference Proposal Reviewer:**

- Annual Conferences
- Mid-Atlantic Conferences

**Article Contributor:** "How the Built Environment Can Support Mental Health on Campus," 2018

**Convener:** 2024, 2023, 2022, 2021, 2019, 2017, and earlier conferences

**Exhibitor:**

- Annual Conference, Long Beach, CA (2022)
- Mid-Atlantic, Washington, DC (2011)
- Annual Conference, Denver, CO (2002)

**Project Tour:** The College of New Jersey's STEM Complex Phase 1, Mid-Atlantic Conference (2017)



Suzanne presenting for AIA | DC webinar.



Suzanne presenting at SCUP Southern Regional Conference in Tampa, FL.



Suzanne with colleague at the 2019 Women's Leadership Summit in Minneapolis, MN.



Suzanne with team at SCUP Annual Conference in Long Beach, CA.

### Ripple Effect:

Suzanne distinguishes herself as a presenter, proposal reviewer, article contributor, and convener with SCUP, an international organization with thousands of members. Her contributions reflect her dedication to advancing the field and sharing valuable insights. She showcased projects such as Middlesex College (Exhibit 3.6), Prince George's Community College (Exhibit 3.1), and Gore Hall (Exhibit 3.8) multiple times.

**Suzanne enriches the academic experience of countless students across various architectural schools through her roles as a panelist, lecturer, competition juror, thesis critic, studio reviewer, and instructor. Her contributions inspire the next generation of architects.**

**2024**

**Juror:** Fourth-year architecture studio, University of Virginia

**2023**

**Juror:** Third-year architecture studio, University of Maryland



*Suzanne at University of Maryland School of Architecture, 2023.*

**2022**

**Juror:** Fourth-year architecture studio, University of Maryland

**Juror:** Super Jury, Catholic University

**2021**

**Juror:** Patrick Cardinal O'Boyle Competition, Catholic University

**Juror:** Interschool Design Competition, Catholic University, Howard University, Morgan State University, Virginia Tech, University of Maryland, and University of the District of Columbia

**Juror:** Super Jury, Catholic University

**Juror:** Thesis Review II, three reviews, Catholic University

**2020**

**Juror:** Patrick Cardinal O'Boyle Competition, Catholic University

**Juror:** Super Jury, Catholic University

**Juror:** Thesis Review I, three reviews, Catholic University

**2020, cont.**

**Panelist:** Alumni Career Chat: Government + Public Sector, Taubman College of Architecture + Urban Planning, University of Michigan



**2019**

**Juror:** Third-year architecture studio, Catholic University

**2018**

**Juror:** Architectural Design II, Catholic University

**2017**

**Juror:** Architectural Foundations III, two reviews, Catholic University

**Juror:** Environmental Design, Catholic University

**2009**

**Juror:** Fourth-year design studio: New building for Columbia University, University of Notre Dame

**1990**

**Teaching Assistant:** History of Architecture 2, University of Michigan

**1989**

**Teaching Assistant:** History of Architecture 1, University of Michigan

“

Suzanne Klein was an exemplary and impactful graduate thesis juror. For the 4+ juries she participated in, her detail-oriented input ranged from 'out-of-the-box' ideas to real-world suggestions. With Suzanne's positive guidance and incredible mentorship, my graduate architectural thesis won the 2019 first-place Super Jury Award and was featured in the Study Architecture Student Showcase."

- **Julia Pryor**, Architectural Designer, Grimm + Parker Architects



*Suzanne served as juror at Catholic University's School of Architecture, 2021.*

### Ripple Effect:

Through her involvement at Catholic University's School of Architecture alone, Suzanne has mentored hundreds of students over the course of their academic careers, assisting their transition into graduate school and professional practice.

**Suzanne's diverse volunteer service propels the AIA's mission for design excellence while tackling vital community needs. She offers skilled guidance to ensure that design enhances quality of life and delivers powerful, sustainable solutions for meaningful change.**

**Spaces Committee Member**

School of Architecture, University of Virginia, Charlottesville, VA (2021-present)

Suzanne's expertise in university planning and donor funding strategies has been instrumental in the development of a major capital campaign for the School of Architecture.

**Governing Board Member**

Little Falls Foundation, Little Falls Presbyterian Church, Arlington, VA (2017-present)

Suzanne stewards the church's buildings, grounds, and financial resources to ensure the congregation's ability to serve others in a positive environment.

**Trustee (Chair, Vice Chair, and Member)**

Little Falls Presbyterian Church, Arlington, VA (2010-2021)

Suzanne guided strategic planning, as well as numerous capital improvement projects, renovations, and landscape design to upgrade the facilities' design quality, longevity, and ability to serve the congregation.

**Ripple Effect:**

Suzanne's involvement in Arlington has impacted hundreds of projects and thousands of residents. The groundwork she advanced continues to propel design excellence and promote the community experience.

**Planning Commissioner**

Arlington County Planning Commission, Arlington County, VA (2010-2014)

Suzanne facilitated meetings with committees and community stakeholders to foster consensus and shape planning initiatives that enrich the county. Often the sole architect on the commission, her leadership and expertise significantly advanced the AIA's mission and influenced key issues in architectural design, land use planning, zoning, mobility, and sustainability.



**Board Member**

Arlington Heritage Alliance, Arlington, VA (2008-2014)

Suzanne championed the preservation and creative repurposing of local historic and culturally significant architectural sites and buildings, enhancing their legacy while underscoring their importance within both the community and the broader national context.

“

Suzanne's leadership has had a tremendous impact on the present and future ministry of Little Falls Presbyterian Church. She spearheaded the renovation of the church facility and formulated a plan to update the sanctuary, chapel, children's spaces, landscaping, and signage. Her contributions to the congregation have been witnessed, utilized, and enjoyed by many.”

- **Rev. Dr. Aaron Nagel**, Senior Pastor, Little Falls Presbyterian Church

“

With her many years of volunteer service to the county, Suzanne Klein helped Arlington become the second best 'city' to live in the U.S. Her leadership influenced preservation, sustainability, and smart growth planning and design in the county while advancing EDI initiatives. Suzanne demonstrated strong skills in building consensus among diverse community stakeholders to advance positive outcomes for the county.”

- **Jay Fisette**, Former Chair/Member, Arlington County Board, 1998-2017



**Suzanne's volunteer service has been instrumental in making Arlington one of the most influential and desirable counties in the nation. Her leadership on the Historical Affairs and Landmarks Review Committee has left a lasting impact on the community.**

#### Chair, Vice Chair, and Member

Historical Affairs and Landmarks Review Board (HALRB),  
Arlington, VA (1997-2004)

Suzanne played a crucial role in elevating preservation efforts and raising awareness in the county, passionately advocating for often-overlooked buildings and sites of cultural significance, particularly within underserved communities. She meticulously reviewed hundreds of projects, positively impacting individuals, families, and neighborhoods by enhancing architectural design, preserving community character, and advancing environmental goals.

#### Chair and Vice Chair

Design Review Committee, HALRB

Suzanne reviewed hundreds of plans and provided design guidance for exterior alterations, demolition, and new construction in locally designated Arlington historic districts through the Certificate of Appropriateness (CoA) process.



*Originally called Maury School, the circa-1910 building, listed on the National Register of Historic Places, now serves as the center for Arlington's arts programs. An addition received an award from the program Suzanne established.*

#### Co-Chair

Historic Preservation Plan for Arlington County Advisory Committee, HALRB

Suzanne initiated the annual Preservation Design Awards Program, noted below, and was a key advocate in advancing the county's Policy Framework for Historic Preservation.

#### Founder and Chair

Preservation Design Awards Program, HALRB (1998-2010)

Suzanne initiated the Preservation Design Awards Program to honor and recognize excellence in design and construction for residential, commercial, and institutional projects in Arlington County. The program increased awareness of the benefit of quality restorations, renovations, additions, and infill structures. Suzanne chaired the program through 2004, served as a juror in 2005, and an advisor through 2010.

#### Representative

Swanson Middle School Addition Committee, HALRB

As the only architect on the committee, Suzanne provided vital planning and design guidance which ultimately saved the architectural integrity of a circa-1939 historic school structure.



*With Suzanne's input, the historic fabric of the original structure remained intact and Swanson continues to be a significant local landmark and middle school.*

“

Suzanne's leadership helped promote environmentally friendly designs that are attractive and people-centered. Her talents advanced Arlington County's Historic Preservation Plan and Suzanne was instrumental in leading community discussions on design and how to create inviting open spaces in an urban setting.”

- **Barbara Favola**, State Senator representing parts of Arlington, Fairfax, & Loudoun, Virginia (2012-present), Arlington County Board Member (1997-2011)

“

Suzanne Klein's commitment and dedication to the HALRB helped shape sensitive alterations and additions to historic properties countywide, while helping raise awareness about the importance of historic preservation in an urban area.”

- **Cynthia Liccese-Torres**, Preservation Coordinator, Arlington County

## 2.2 SIGNIFICANT HONORS, AWARDS, AND RECOGNITION

Suzanne's contributions to collegiate project typologies have been recognized by AIA chapters, trade associations, and allied organizations throughout the country.

### AIA AWARDS



**AIA, Aspire Design Award – New Construction, 2022**  
McLeod Tyler Wellness Center, College of William & Mary, Williamsburg, VA



**AIA Connecticut Chapter, Excellence in Design Award, 2020**  
McLeod Tyler Wellness Center, College of William & Mary, Williamsburg, VA

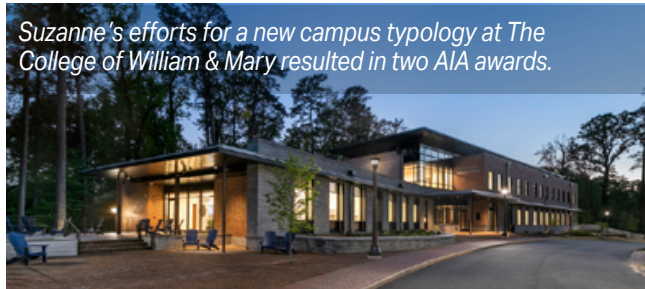

Suzanne's efforts for a new campus typology at The College of William & Mary resulted in two AIA awards.



**AIA Maryland Chapter, Excellence in Design Award, 2016**  
Duke Kunshan University, Kunshan, China



**AIA Northern Virginia Chapter, Jurors' Citation Award, 2016**  
Duke Kunshan University, Kunshan, China



Suzanne's expertise empowered Duke University to expand their educational reach in China.

### SELECTED OTHER AWARDS

**Metro Washington and Virginia Chapters of Associated Builders and Contractors, Excellence in Construction Award, 2022**  
E.A. Fernandez IDEA Factory, University of Maryland, College Park, MD

**IIDA Mid-Atlantic Chapter, Sustainability Advancement Award – Premier Design Award, 2020**  
McLeod Tyler Wellness Center, College of William & Mary, Williamsburg, VA

**Architizer A+ Awards, Institutional – Higher Education & Research Facilities, 2020**  
McLeod Tyler Wellness Center, College of William & Mary, Williamsburg, VA

**Economic Benefit to New Jersey, Catalyst Award, 2017**  
STEM Complex, The College of New Jersey, Ewing, NJ

**Chestertown Planning Commission, Best Building Award – Institutional, 2016**  
Cromwell Hall Academic Building, Washington College, Chestertown, MD

**Design-Build Institute of America, National Design-Build Award, 2011**  
The Mason Inn Conference Center & Hotel, George Mason University, Fairfax, VA

**Mid-Atlantic Construction Magazine, Project of the Year, 2010**  
The Mason Inn Conference Center & Hotel, George Mason University, Fairfax, VA

**Historical Society of Princeton, Historic Preservation Award, 2006**  
Aaron Burr Hall, Princeton University, Princeton, NJ

**Cast Stone Institute, Design Excellence Award, 2002**  
The Humanities Building, Rice University, Houston, TX

**Cast Stone Institute, Manufacturing Excellence for Dallas Cast Stone, 2002**  
The Humanities Building, Rice University, Houston, TX

**Masonry Contractors Association of America, International Excellence in Masonry Award, 2002**  
The Humanities Building, Rice University, Houston, TX

**Texas Masonry Council, Golden Trowel Award, 2002**  
The Humanities Building, Rice University, Houston, TX

**Delaware Contractors Association, Excellence in Construction Award**  
Du Pont Hall, University of Delaware, Newark, DE, 2001  
Gore Hall, University of Delaware, Newark, DE, 1999

### PERSONAL AWARDS

**Tau Sigma Delta, National Architectural Honor Society, 1989**

**Winner, American Institute of Architects/American Architectural Foundation Scholarship for Professional Degree Candidates, 1989**



The design of an entire campus from scratch can risk architectural tedium, yet this six-building complex is vibrant and fresh."

- AIA Maryland Jury Comments



Aiming to create transformative places and spaces, Suzanne shares her expertise and insights from her projects through articles and digital platforms, inspiring design excellence and influencing her peers in the architecture profession.

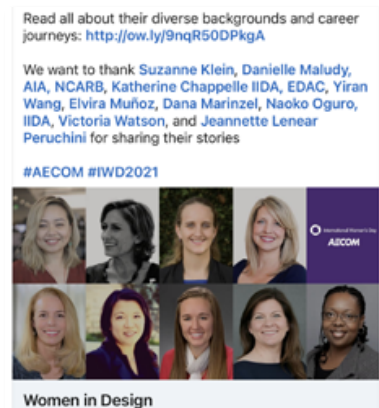
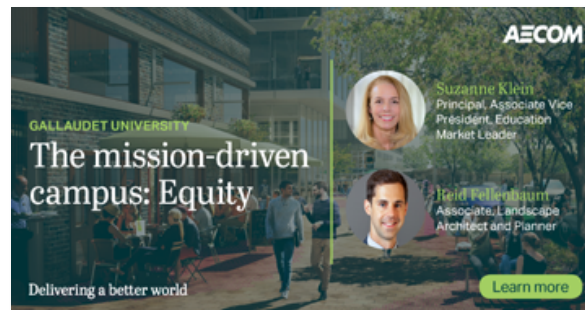

## ARTICLES BY SUZANNE

"Growing Together: Supporting Equitable Opportunities for All," *LinkedIn* thought leadership article, 2023

"A Destination for Everyone: Improving the Campus Experience," *LinkedIn* thought leadership article, 2023

"Growing Together: Campus Planning that Advances a Thriving, Diverse Community," *LinkedIn* thought leadership article, 2023

"The Mission-Driven Campus: Achieving a Net-Zero Future," *AECOM*, 2022

"Designing for the Mission-Driven Campus: Flexibility," *AECOM*, 2022

"Designing for the 21st Century Student," *AECOM*, 2022

"STEM for a Post-COVID World," *AECOM*, 2020

"McLeod Tyler Wellness Center at William & Mary," *Inform Magazine*, 2020

"Wellness Trend on Campuses: Prevention vs. Intervention," *EYP Online*, 2018

"How the Built Environment Can Support Mental Health on Campus," Contributor, *Learning by Design*, Society for College and University Planning, 2018

"The Creation of an Invisible City: Continuous Cities," *Dimensions*, College of Architecture and Urban Planning, University of Michigan, 1990

## PUBLICATIONS ABOUT SUZANNE

"People Spotlight Series: Meet Suzanne Klein," *AECOM*, 2021

"Women in Design," *AECOM*, 2021



**Suzanne's projects have received widespread recognition in national and local publications, trade journals, newscasts, and blogs for their contributions to college and university campuses.**



Announcement by NJ Gov. Phil Murphy, county officials, and Middlesex College President Mark McCormick envisioning the campus as a regional destination. (See hyperlink in second column for article.)

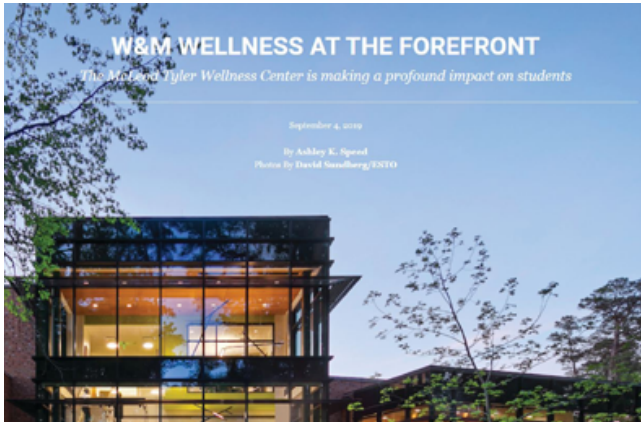

Suzanne's efforts enabled the well-publicized McLeod Tyler Wellness Center to make a profound impact on students. (See hyperlink in third column for article.)

### Master Plan and Phase 1 Buildings (Exhibit 3.6)

**Middlesex College, Edison, NJ**

[Middlesex County Unveils Designs to Transform College into Regional Hub \(\[mycentraljersey.com\]\(#\)\)](#), *MyCentralJersey.com*, 2024

"Middlesex College Campus to be Transformed Under a New Education and Infrastructure Plan," *Middlesex College*, 2022

"Development Plan Seeks to Transform Middlesex College in Edison, N.J., into a Regional Destination," *American School & University*, 2022

"Middlesex County Announces the Community, Innovation, and Opportunity (CIO) Strategic Investment Plan to Transform Middlesex College into a Leading Destination in New Jersey," *Insider NJ and Middlesex County NJ News*, 2022

### E. A. Fernandez IDEA Factory (Exhibit 3.3)

**University of Maryland, College Park, MD**

[Introducing the E.A. Fernandez IDEA Factory \(\[youtube.com\]\(#\)\)](#), *University of Maryland*, 2022

"UMD Dedicates IDEA Factory," *University of Maryland*, 2022

"University of Maryland Adds \$67M IDEA Factory," *Maryland Daily Record*, 2022

"IDEA Factory at U. of Maryland Defies Gravity," *Building Design and Construction*, 2022

### Life Sciences and Engineering Building

**George Mason University, Manassas, VA**

[Mason's Science and Technology Campus is About to be Transformed \(\[gmu.edu\]\(#\)\)](#), *George Mason University*, 2022

"Topping Out the New Sci-tech Campus Building," *George Mason University*, 2023

"Life Sciences and Engineering Building: Construction at Mason," *George Mason University*, 2019

### STEM Complex Phases 1, 2, & 3 (Exhibit 3.5)

**The College of New Jersey, Ewing, NJ**

"The College of New Jersey – STEM Complex," *Education Snapshots*, 2019

[The College of New Jersey Opens \\$76M STEM Complex \(\[nj.com\]\(#\)\)](#), *NJ.com*, 2017

"N.J.'s \$750 Million Investment in Colleges Starts to Pay Off," *NJ.com*, 2017

"New \$96 Million STEM Complex at The College of New Jersey Inspires Cross-Disciplinary Collaboration and Innovation: Project Adds Space, Functionality, Advanced Technology, and Flexibility," *Tradeline*, 2016

### McLeod Tyler Wellness Center (Exhibit 3.2)

**College of William & Mary, Williamsburg, VA**

[W&M Wellness at the Forefront \(\[wm.edu\]\(#\)\)](#), *William & Mary Alumni Magazine*, 2019

"Biophilia Brings Nature to Work with You," *Washington Business Journal*, 2021

"McLeod Tyler Wellness Center: One Year Later," *YouTube* uploaded by William & Mary, 2020

"McLeod Tyler Wellness Center at William & Mary," *Inform Magazine*, 2020

"How the Built Environment Can Support Mental Health on Campus," *Learning by Design, SCUP*, 2018

“

Suzanne's leadership and contributions to the Duke Kunshan Campus allowed this project to become the world class institution that it is. This AIA award-winning campus is now the benchmark in China for the design of academic buildings and became the first LEED-certified project in the country.”

- **Jordan Goldstein, FAIA, FIIDA**, Co-Firm Managing Principal



[Click to hear more at Wooster Opens Spectacular New Life Sciences Building – Bing video ►](#)

#### Master Plan & Phase 1 Buildings

**Duke Kunshan University**, Kunshan, China

[Pushing for Academic Freedom in China \(npr.org\)](#), NPR, 2019

“Applicants for Slots at its Kunshan, China Campus Swamping Duke Projections,” *Herald Sun*, 2018

“It’s Full Speed Ahead at Duke to Bring More Students to its China and Durham Campuses,” *Herald Sun*, 2017

“Duke Kunshan University,” *Architect Magazine*, 2016

#### Ruth W. Williams Hall of Life Science

**College of Wooster**, Wooster, OH

“Open House for Ruth W. Williams Hall of Life Science Set for Friday, Aug. 17,” *Wooster Daily Record*, 2018

[COW’s New Science Building Almost Ready for Unveiling \(the-daily-record.com\)](#), *Wooster Daily Record*, 2018

“Guests Get Peek at New College of Wooster Science Building,” *Wooster Daily Record*, 2017

#### Cromwell Hall Academic Building

**Washington College**, Chestertown, MD

“Planners Choose Best Building Awards,” *Kent County News*, 2017

[WC’s Cromwell Hall Ready for Fall Semester \(stardem.com\)](#), *Star Democrat*, 2016

“Dedication for Washington College’s New Academic Building, Cromwell Hall,” *Chestertown Spy*, 2016

“Feeling Dedicated,” *Washington College*, 2016

#### Integrated Science Center Phase 3

**College of William & Mary**, Williamsburg, VA

[Looking Forward to the Opening of the Integrated Science Center, Phase 3 \(wm.edu\)](#), *William & Mary News*, 2016

“A Small Step for Party Planning, a Giant Leap for Integrating the Sciences,” *William & Mary News*, 2016

“William & Mary Building Toward a Bright Future,” *William & Mary News*, 2016

“Integrated Science Center: Phase 3 Set to Stun,” *William & Mary News*, 2016

#### Gibbons House (Exhibit 3.7)

**University of Virginia**, Charlottesville, VA

[Gibbons House Dedication Memorializes Former Slaves, Successful Free Lives \(virginia.edu\)](#), *UVA Today*, 2015

“New UVA Residence Hall, Gibbons House, Named for Former Slave Couple,” *Augusta Free Press*, 2015

“U.Va. Naming New Dorm After Once-Enslaved Couple,” *WSLS Channel 10 News*, 2015

#### Charles E. Smith Center (Exhibit 3.4)

**George Washington University**, Washington, DC

“A Place of Community: The Charles Smith Center at 40,” *GW Magazine*, 2015

“The Charles E. Smith Center,” *George Washington University Athletics*, 2015

“Smith Center Awarded LEED Gold Certification,” *GW Today*, 2012

[Honoring a GW Landmark \(gwu.edu\)](#), *GW Today*, 2011



Aaron Burr Hall featured in *Architect Magazine*.



The Humanities Building featured in *Architectural Record* magazine.



The Humanities Building featured on the cover of *College Planning & Management*.



The Humanities Building's sallyport featured on the cover of Rice University's *Sallyport* magazine.

### The D'Angelo Center

**St. John's University**, Queens, NY

"St. John's University, The D'Angelo Center," *School Designs*, 2012

### Aaron Burr Hall

**Princeton University**, Princeton, NJ

"Richard Morris Hunt, Revisited: Allan Greenberg Architect and KSS Architects Rework a Forgotten Building by an American Master on the Princeton University Campus," *Architect Magazine*, 2008

"Something Old, Something New: A Prize-Winning Architect at Princeton (Featuring Aaron Burr Hall)," *Slate*, 2006

### The Humanities Building (Exhibit 3.9)

**Rice University**, Houston, TX

"Strangely Familiar (Featuring The Humanities Building, Rice University)," *Architectural Record*, 2003

"Honoring the Exterior," *College Planning & Management*, 2002

"Stalwart Classicist Allan Greenberg Takes on the Fantastic, Neo-Byzantine Idiom of Ralph Adams Cram," *Architect Magazine*, 2001

"Building Boom!," *Sallyport*, 2000

### Du Pont Hall

**University of Delaware**, Newark, DE

[Du Pont Hall Dedicated Sept. 22 \(udel.edu\)](http://udel.edu), *University of Delaware*, 2002

"Du Pont Hall Almost Done, Construction Continues on Other Projects Across Campus," *University of Delaware*, 2002

"Completing the Original," *American School & University*, 2001

### Gore Hall (Exhibit 3.8)

**University of Delaware**, Newark, DE

University of Delaware's Gore Hall, *Design Cost Data*, 1999

[Gore Hall, New Classroom Building, a 'Magnificent Landmark' for the Mall \(udel.edu\)](http://udel.edu), *University of Delaware Messenger*, 1998

### Ripple Effect:

Suzanne's projects have garnered significant coverage in both print and online media, appearing in professional and collegiate publications that reach hundreds of thousands of alumni.



## 2.4 SIGNIFICANT PRESENTATIONS AND SPEAKING ENGAGEMENTS

Suzanne shares her experience with audiences nationwide, addressing collegiate planning and design issues that promote the academic mission. Her presentations reflect her passion for fostering engagement, belonging, and enriching the community experience.



*Suzanne and PGCC's president presented at SCUP Mid-Atlantic in 2024*



*Suzanne presented the Middlesex College plan at four conferences*



### 2024

**Presenter:** "Campus Master Planning as a Catalyst for Broader Community Impact," Society of College and University Planning (SCUP) Annual Conference, Philadelphia, PA

**Panelist:** "Invest in Women," Ascent International Women's Day Event, Arlington, VA

**Presenter:** "A New Campus Model for Greater Community Impact and Connection," SCUP Mid-Atlantic Regional Conference, Fairfax, VA

### 2023

**Presenter:** "Campus Master Planning as a Catalyst for Broader Community Impact," Campus Facilities Summit, Philadelphia, PA

**Presenter:** "Campus Master Planning as a Catalyst for Broader Community Impact," AIA | DC Committee on Architecture for Education, Back to School Fall Social, Washington, DC

**Panelist:** "Careers in Architecture," Women in Architecture, University of Maryland Chapter, College Park, MD

**Presenter:** "Master Planning as a Catalyst for Broader Economic Development," SCUP Mid-Atlantic Regional Conference, Philadelphia, PA

**Presenter:** "Master Planning as a Catalyst for Broader Economic Development," SCUP Southern Regional Conference, Tampa, FL

### 2022

**Presenter:** "Cognitive Ergonomics: Research Data and Workspace Designs that Drive Workplace Performance," Tradelane Space Strategies Conference, Austin, TX

### 2021

**Lecturer:** "One World Many Goals: Diverse Approaches to Well-Being in Practice," for Human Centric Evidence Based Design for Well-Being course, Catholic University, Washington, DC

### 2020

**Lecturer:** "Wellness Center Design," for Neuroarchitecture for Well-Being course, Catholic University, Washington, DC

**Moderator:** "STE(A)M for a Post-COVID World," AECOM Virtual Roundtable

**Panelist:** "How Design Can Reduce Stress & Anxiety," AIA|DC Webinar, virtual

### 2019

**Lecturer:** "Wellness Center Design," for Civic Architecture for Well-Being course, Catholic University, Washington, DC

### 2010

**Presenter:** "From Green to Green: Comprehensive Sustainable Master Planning for Lynn University," SCUP Mid-Atlantic Conference, Baltimore, MD

### 2007

**Presenter:** "Greening Legacy Structures: New Strategies for Old Favorites," Traditional Building Conference, Boston, MA

### 2006

**Presenter:** "The Historic Campus: Living with a Legacy in Today's World," Traditional Building Conference, Washington, DC

### 2003

**Presenter:** "The Historic Campus Core: Balancing the Assets and Liabilities," SCUP Mid-Atlantic Conference, Washington, DC

### 2001

**Presenter:** "Constructability and the Historical Campus: Cohesion or Collision?," SCUP Mid-Atlantic Conference, Newark, DE

### Ripple Effect:

Suzanne features content from her projects in many of her presentations, reaching thousands of professionals across the country.

“

"Suzanne is quite literally a superstar! I was completely floored with everything she presented. My sister has special needs and we had to use sign language to communicate with her. Hearing Suzanne talk about it and implement innovation for the hard of hearing at such a large scale was AMAZING!"

- **Claire Beins**, Catholic University student on Suzanne's *One World, Many Goals* lecture

## 3.0 EXHIBITS

Each exhibit illustrates Suzanne Klein's themes for Practice Technical Advancement by transforming campus typologies, driving design excellence, and inspiring generations of professionals while incorporating the AIA Framework for Design Excellence.

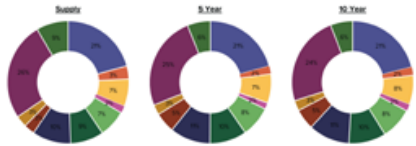

**3.1**  
**Leveraging Qualitative and Quantitative Data in Collegiate Practice**



**3.6**  
**Master Plan and Phase 1 Buildings**  
Middlesex College, Edison, NJ



**3.2**  
**McLeod Tyler Wellness Center**  
College of William & Mary, Williamsburg, VA



**3.7**  
**Gibbons House**  
University of Virginia, Charlottesville, VA



**3.3**  
**E.A. Fernandez IDEA Factory**  
University of Maryland, College Park, MD



**3.8**  
**Gore Hall**  
University of Delaware, Newark, DE



**3.4**  
**Charles E. Smith Center**  
George Washington University,  
Washington, DC



**3.9**  
**The Humanities Building**  
Rice University, Houston, TX



**3.5**  
**STEM Complex Phases 1, 2, & 3**  
The College of New Jersey, Ewing, NJ



**3.10**  
**Mentoring Emerging Leaders**

### 3.1 Leveraging Qualitative and Quantitative Data in Collegiate Practice

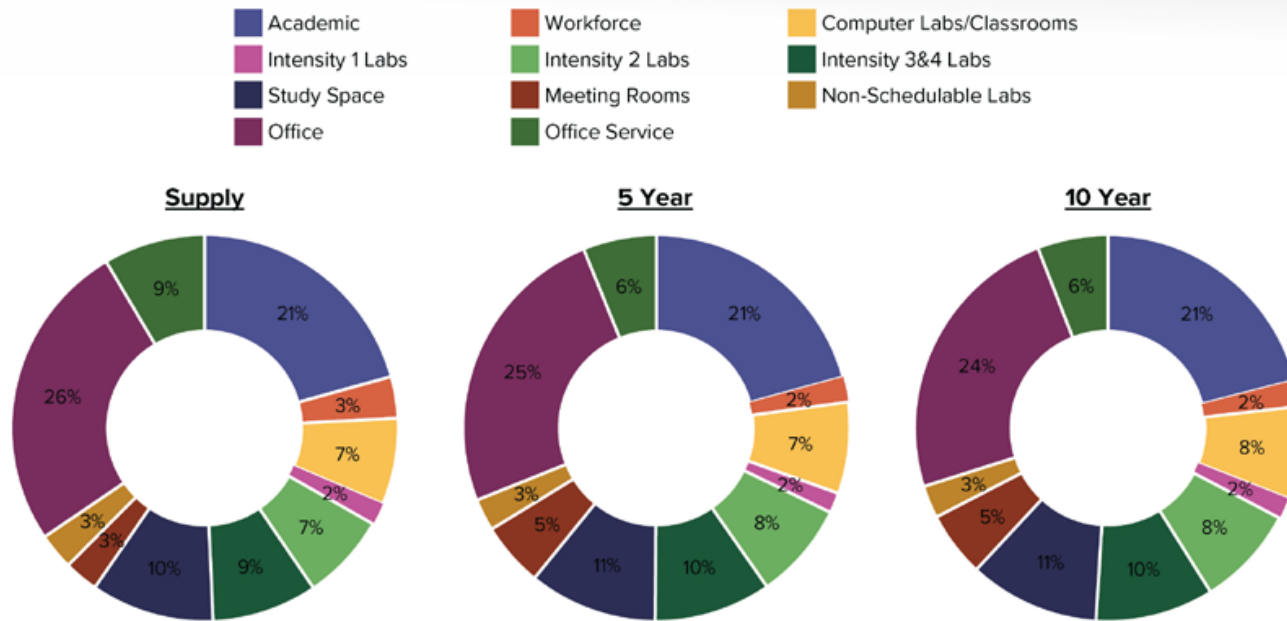

**Innovative Needs Assessment:** To determine Middlesex College's (see Exhibit 3.6) future space needs, data-driven supply and demand models ascertained space requirements, which informed the achievable and flexible campus program. Suzanne presented the college plan at conferences and in thought leadership articles.

## Methodology to Propel Engaged Learning, Belonging, and Community Building

**Challenge:** In today's demanding data-rich world, campus leaders need expertise to decipher, align, and provide clear, fact-based information for effective decision-making to ensure inclusivity and design excellence.

**Role & Process:** Suzanne leverages data, research, and user input while mentoring her team to propel design excellence for projects of all types. **Her bespoke strategies ignite the project vision, balancing qualitative and quantitative insights to drive institutional progress.** Her cutting-edge methodologies include:

- **Dynamic Data Integration:** Suzanne employs hybrid data collection, blending surveys, polls, and focus groups with real-time analytics. She incorporates comprehensive data through custom interactive dashboards, setting a clear course for impactful decision-making.
- **Collaborative Stakeholder Engagement:**

By orchestrating inclusive, collaborative processes, Suzanne unites diverse perspectives. She merges qualitative insights with quantitative metrics to chart a definitive direction and create exceptional outcomes.

- **Equity-Driven Advancement:** Leveraging extensive datasets — student demographics, educational access, and workforce dynamics — Suzanne ensures outcomes are transparent, equitable, and supportive of campus inclusion and diversity goals.
- **Strategic Benchmarking:** Suzanne applies benchmarking data for campus plans and new buildings, enabling institutions to elevate their competitiveness, attract top students and faculty, and assess performance.
- **Innovative Needs Assessment:** She conducts assessments by analyzing space needs, functional relationships, and existing conditions. Utilizing proprietary digital tools, Suzanne integrates quantitative and

qualitative stakeholder data and real-world observations to refine strategies.

- **Tailored Program Development:** Understanding each project's opportunities, Suzanne guides clients with advanced tabular and graphic tools, planning metrics, and technical criteria to create precise and aspirational solutions.

**Impact:** Suzanne's methodology blends qualitative and quantitative data to **guide and enrich collegiate planning and design, fostering engaged learning, belonging, and community building.** As a mentor, she shares expertise with staff, nurturing growth in collegiate planning and design. Her projects are highlighted at national conferences and featured in influential articles.

**Key Project Aspects:** Integration | Equitable Communities | Ecosystems | Water | Economy | Energy | Well-being | Resources | Change | Discovery

**Architecture Firm of Record/Design Firm:** AECOM, EYP, KlingStubbins, Gensler, Allan Greenberg Architect

**Completed:** Ongoing

**Role:** Principal in Charge, Education Practice Leader, Project Director, Project Manager

**Select Publications:**

"A Destination for Everyone: Improving the Campus Experience," *LinkedIn* article, 2023

"The Mission-Driven Campus: Achieving a Net-Zero Future," *AECOM*, 2022

"Designing for the Mission-Driven Campus: Flexibility," *AECOM*, 2022

"Designing for the 21st Century Student," *AECOM*, 2022



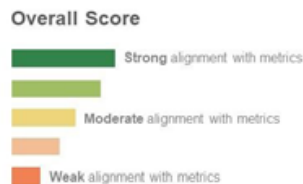

**Dynamic Data Integration:** Leading a multidisciplinary team for Prince George's Community College (PGCC, see page 8), Suzanne spearheaded the interactive digital dashboard's multi-criteria framework that integrated qualitative stakeholder input and quantitative regional metrics.

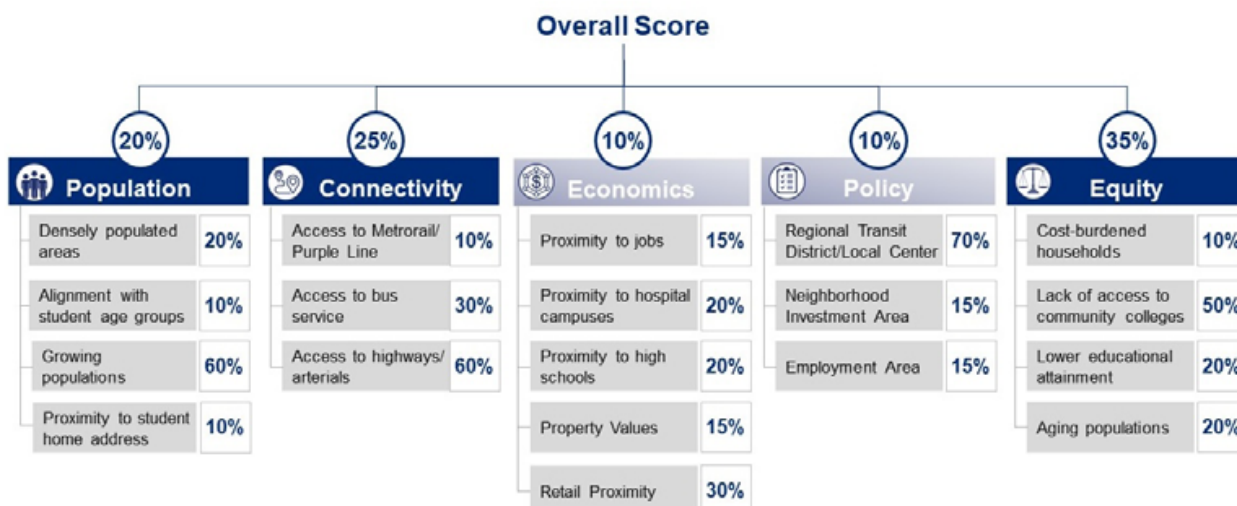

**Equity-Driven Advancement:** Located in a minority-majority county, PGCC sought to reimagine its main campus and develop a Three Campus Model to serve a broader range of constituents and underserved populations. The data-driven approach was developed to advance equity by balancing stakeholder input with metrics from the digital dashboard. It resulted in consensus on two new campuses and a forward-thinking main campus plan.



**Tailored Program Development:** For the Integrated Science Center Phase 3 at the College of William & Mary (see Page 7), Suzanne facilitated stakeholder and technical team workshops to design spaces that promote collaboration and enhance interdisciplinary study and research. This initiative served as a catalyst, influencing similar projects nationwide.

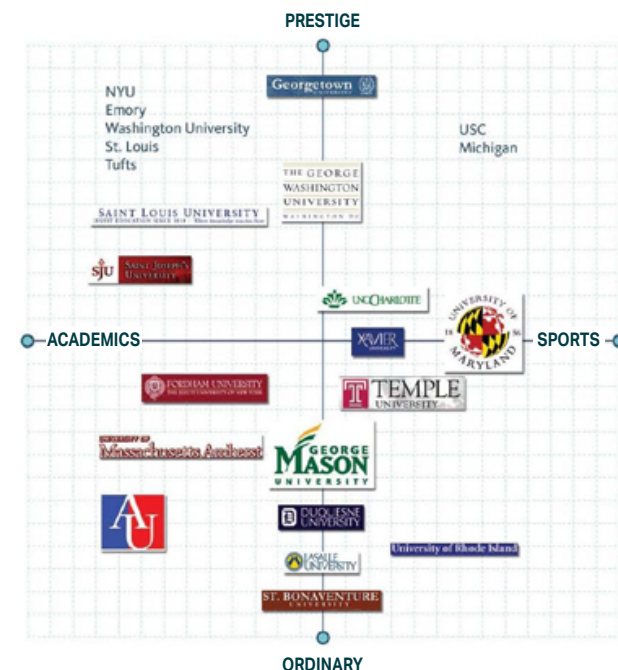

**Strategic Benchmarking:** For the Smith Center (Exhibit 3.4), Suzanne used a competition grid to illustrate how transforming an initially small project into a comprehensive renovation could invigorate the GW community and student-athlete experience while elevating GW's prestige in academics and athletics.

“

The Board of Trustees unanimously and enthusiastically approved the Three Campus Model Report. I congratulate you and your team ... for making it an important part of the College's future growth and further evolution into the 21st century.

- **Donald W. Pruett**, Director Planning, Design & Construction, Prince George's Community College

#### Declaration of Responsibility:

I have personal knowledge of the nominee's responsibility for the content in this exhibit. That responsibility included projects under the direction of the nominee.

- **Gerald Briggs, FAIA**, AECOM, Principal and Vice President



## 3.2 McLeod Tyler Wellness Center

College of William & Mary, Williamsburg, VA



Expansive views of the woodland setting offer a calming and restorative atmosphere.

## Creating a New Paradigm for Student Wellness

**Challenge:** The college's health and wellness facilities were scattered throughout campus and many of the 9,600+ students were deferring treatment until they were in crisis. As anxiety and depression among students was escalating, the administration deemed it imperative to create one integrated center for the college community.

**Role:** By empowering campus leadership with a non-traditional vision for this building typology, **Suzanne spearheaded the creation of a new collegiate building paradigm and mentored a team that took wellness concepts to a new level** by incorporating evidence-based planning and innovative design strategies in a holistic environment where students flourish and build resilience.

**Impact:** Suzanne's leadership resulted in an award-winning LEED Gold facility that integrates

a clinic, counseling center, and recreational and wellness spaces with a design that is welcoming to all in appearance and plan – engaging students and drawing them into the building for services without hesitation.

Use of the center is higher than anticipated. Overwhelmingly positive feedback from students, staff, administration, and an independent research team affirms the building is reducing the stigma of seeking help and is achieving the intended results. Post-occupancy data reflects that over 90% of students recommend the center's services to others. **Suzanne's attentiveness to staff concerns resulted in a highly efficient layout that optimizes healthcare personnel's operational needs** – staff noted, "the design of my workplace empowers me to be more productive."

The director of the center noted that **Suzanne's leadership in the creation of this new typology has generated a significant and positive shift in the well-being of the entire William & Mary campus community.** College President Katherine A. Rowe noted, "Not only has [the Wellness Center] fulfilled everything that we hoped for, but so much more."

This award-winning campus paradigm has been featured in many publications. Suzanne led a building tour for facilities professionals at the 2020 VAPPA Conference and her mentees are continuing to promote wellness strategies across the country.

**Key Project Aspects:** Well-being | Integration | Ecosystems

**Architecture Firm of Record/Design Firm:** EYP

**Completed:** 2018

**Role:** Senior Project Director

**Select Awards:**

**AIA, Aspire Design Award – New Construction, 2022**

**AIA Connecticut Chapter, Excellence in Design Award, 2020**

**IIDA Mid-Atlantic Chapter, Sustainability Advancement Award – Premier Design Award, 2020**

**Architizer A+ Awards, Institutional – Higher Education & Research Facilities, 2020**

**Publications:** Refer to page 16





Multi-purpose studios accommodate diverse wellness activities such as yoga, tai chi, and mindfulness seminars. The floor to ceiling glazing throughout the building intentionally creates a connection to nature, one of numerous positive distractors employed in the project.

“

Every square inch of this building has a purpose that serves our vision and we relied heavily on Suzanne's brilliance and sensitivity to get it done the right way. The result has been a significant shift in how our students, staff, and faculty perceive wellness.”

- **Dr. Kelly Crace**, Associate Vice President for Health & Wellness, College of William & Mary

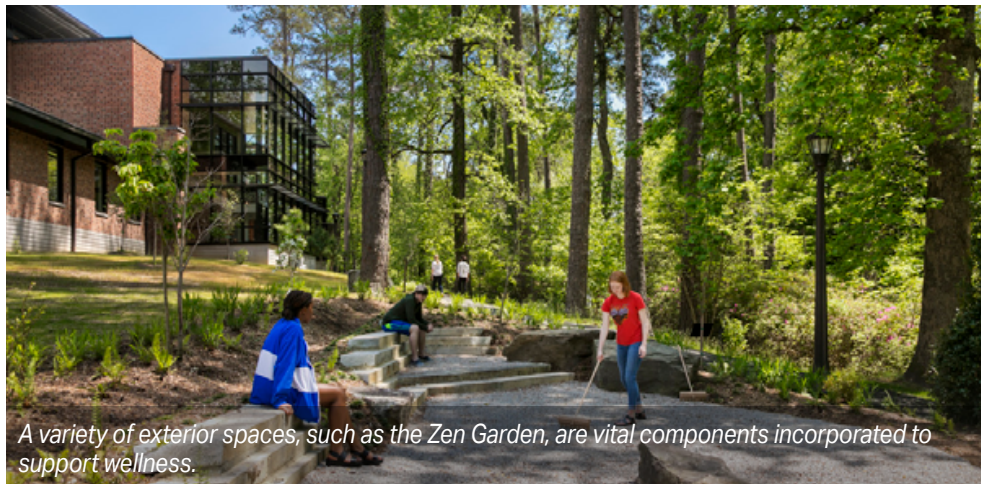

A variety of exterior spaces, such as the Zen Garden, are vital components incorporated to support wellness.

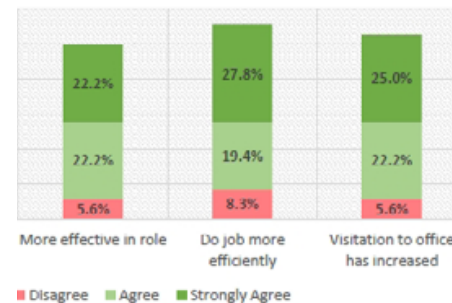

A research study noted that staff feel more productive in the new facility.



“I’m really excited and passionate about the Wellness Center because I do see it making actual change on our campus...”

- **Kate Donati**, 2020 graduate and yoga instructor

[Click to hear more about the Wellness Center](#)

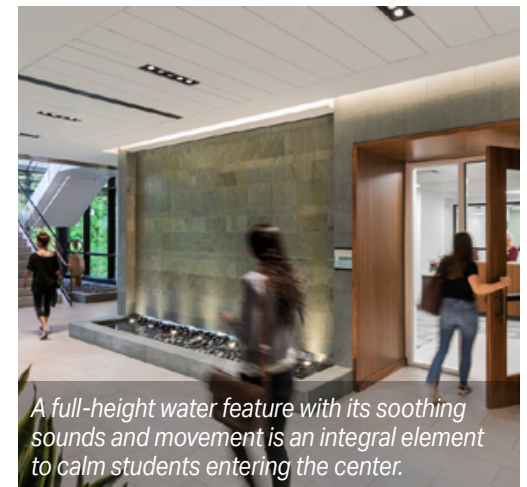

A full-height water feature with its soothing sounds and movement is an integral element to calm students entering the center.



Spaces such as this Meditation Alcove promote wellness throughout; window is located at seated level.

#### Declaration of Responsibility:

I have personal knowledge of the nominee's responsibility for the **McLeod Tyler Wellness Center**. That responsibility included: Project under direction of nominee.

- **Catherine Parker**, Senior Project Manager, College of William & Mary



### 3.3 E.A. Fernandez IDEA Factory

University of Maryland, College Park, MD



Located in the heart of the College Park campus, the IDEA Factory intentionally deviates from the traditional campus vernacular with its unique massing and materials.

## Thinking, Making, Modeling to Spur New Innovations

**Challenge:** The IDEA Factory was conceived to expand the boundaries of innovation, cutting-edge research, and entrepreneurship in a unique campus typology. The team had the formidable task of embodying the donor's goal of "reaching for the stars" while integrating one-of-a-kind engineering, science, arts, and business programs on the tight site.

**Role:** For this design-build project, Suzanne integrated qualitative and quantitative data to promote interdisciplinary engagement. To optimize the budget, maintain the aggressive schedule, and fulfill the ambitious vision, Suzanne knew innovative design and technical strategies were necessary.

In lieu of traditional schematic design, she pioneered daily charrettes to quickly define alternate schemes, identify material options, and obtain immediate cost feedback to develop this groundbreaking facility. **Her leadership,**

**expertise, and mentorship in program development was pivotal in crafting expertly designed layouts that seamlessly accommodate the technical demands of a robotics laboratory, a quantum technology center, and even a café – an unprecedented integration within a single building.** To navigate challenging presentations with the campus's conservative review board, Suzanne masterminded a convincing strategy showcasing cutting-edge design over the university's traditional vernacular.

**Impact:** University staff cite Suzanne's leadership as key to the project's success. In his dedication speech, President Darryll Pines lauded the building's transformational impact on innovation, research, and product development for the university and beyond. **Students and faculty collaboratively conceive ideas, build prototypes, and create products in an unprecedented campus typology that**

**spurs economic development globally.** The building houses some of the most advanced research spaces and laboratories in academia where interdisciplinary students work together on large research projects and create entries for national competitions. The building's Startup Shell, an incubator to develop student-led startups, has already generated over 60 ventures valued over \$20 million.

**The iconic five-story structure defies gravity and its dichroic glass changes with the light, pushing design boundaries and innovation for future campus buildings.** The IDEA Factory was featured in numerous articles and showcased on a tour at the 2024 AIA National Convention.

**Key Project Aspects:** Integration | Change | Discovery

#### Architecture Firm of Record/Design Firm:

Design-Build: EYP and Clark Construction

**Completed:** 2021

**Role:** Senior Project Director

#### Select Awards/Publications:

**Metro Washington and Virginia Chapters of Associated Builders and Contractors, Excellence in Construction Award, 2022**

"UMD Dedicates IDEA Factory," *University of Maryland*, 2022

"Introducing the E.A. Fernandez IDEA Factory," *YouTube* uploaded by UMD, 2022

"University of Maryland Adds \$67M IDEA Factory," *Maryland Daily Record*, 2022



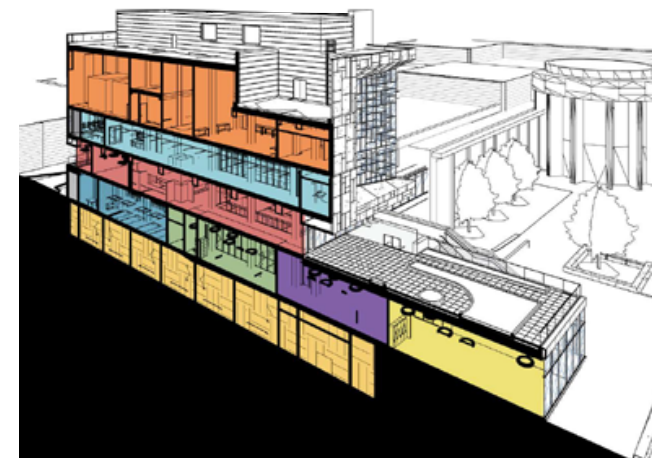

*The street level showcases entrepreneurship. Students share technology in the Rapid Prototyping Lab (green), prepare for design competitions in the ALEx Garage (blue) and create apps in the Startup Shell (yellow). The second level integrates a café (red) and adjacent terrace to promote collaboration. Robotics (aqua) and Rotorcraft (orange) are located above. Below ground, the Quantum Technology Center (gold), houses advanced sensitive equipment.*

“

Suzanne's hands-on approach and involvement resulted in a building that quickly became the campus's beacon for the School of Engineering, and one that visually represents the future of research and unhindered possibilities. Without Suzanne's leadership, I am sure that we would not have achieved this level of success."

- **Daniel Pierce**, Associate Director, Department of Planning & Construction, University of Maryland

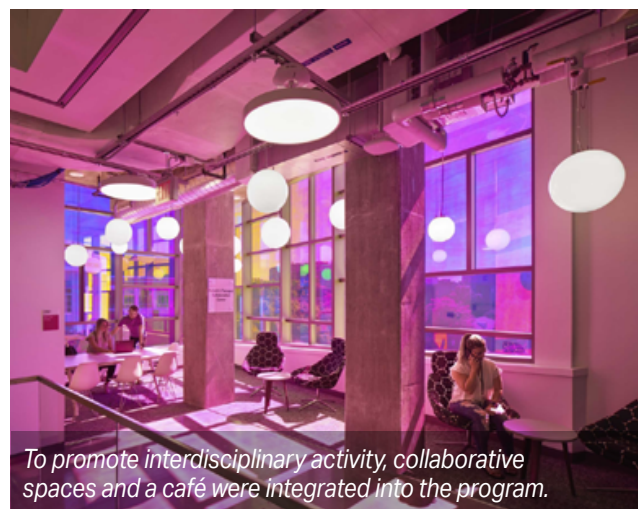
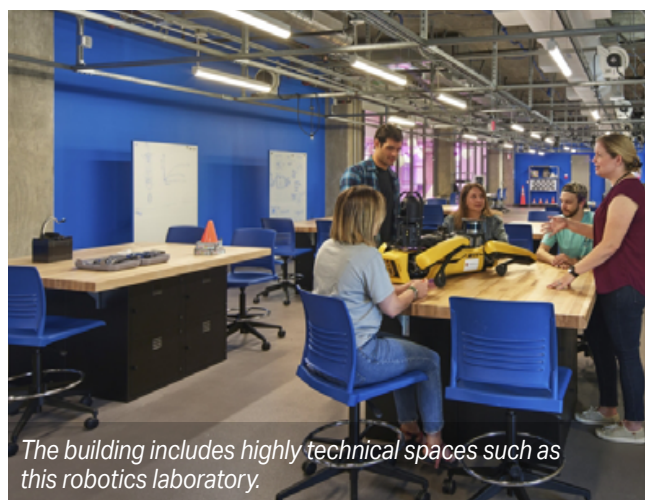

#### **Declaration of Responsibility:**

I have personal knowledge of the nominee's responsibility for the **E.A. Fernandez IDEA Factory**. That responsibility included: Project under direction of nominee.

- **Sandie Williams**, Project Manager, University of Maryland



### 3.4 Charles E. Smith Center

George Washington University, Washington, DC



*The transformed facility creates an exciting presence in the community especially during games and special events.*

## Generating Excitement to Advance the Student Athlete and Community Experience

**Challenge:** This outdated athletic facility was impeding recruiting efforts and not supporting the campus community, but George Washington University (GW) lacked a funding strategy for improvements.

**Role:** With spartan funds, GW proposed modest changes; however, Suzanne knew donors were unlikely to contribute to an underwhelming renovation. Encouraging GW to think big, she devised a bold concept that expanded the building's uses and elevated its design presence to capture the imaginations of key donors. **Suzanne led the design while mentoring an all-woman design team, most of whom were new to collegiate projects.** To improve student outcomes and better serve the community, she used strategic benchmarking and formulated an experience mapping journey to generate excitement during memorable events such as convocation, graduation, and game nights.

**Impact:** Emphasizing the donors' legacy, the facility as the heart of the campus, and building pride in the GW community, **Suzanne's strategy was a hit resulting in a \$10-million seed donation – the largest in GW's history at the time.** It was quickly matched, enabling the project to proceed.

The transformed Smith Center enriches the campus life experience for the 26,000+ students who begin and end their GW careers with convocation and graduation ceremonies in the building. Citing Suzanne's contributions, the former Director of Construction notes **her work on the renovation significantly enhances the university community.**

The LEED Gold Smith Center is now a recruiting tool to attract potential athletes and incorporates an academic center crucial to improving students' educations. With potential athletic recruits excited about practicing and playing

in the facility, the Smith Center is now a factor in athletic success. Within two seasons, the men's basketball team received a 2014 NCAA Tournament bid, its first since 2007.

**Suzanne transformed an underperforming athletic building typology into a multi-use facility that continues to support the entire campus community.** The arena, with its

5,000-person capacity and 130+ events per year, now generates a critical revenue stream for academic programs and athletic activities. Spaces Suzanne developed encourage participation of the 320,000+ alumni patrons as key contributors to their alma mater.

**Key Project Aspects:** Integration | Equitable Communities | Well-being

#### Architecture Firm of Record/Design

**Firm:** Gensler

**Completed:** 2011

**Role:** Project Manager & Education Practice Leader

#### Select Publications:

"A Place of Community: The Charles Smith Center at 40," *GW Magazine*, 2015

"The Charles E. Smith Center," *George Washington University Athletics*, 2015

"Smith Center Awarded LEED Gold Certification," *GW Today*, 2012

"Honoring a GW Landmark," *GW Today*, 2011





The Arena, the exciting heart of the building, is used for men's and women's athletics, graduation, and alumni and community events.

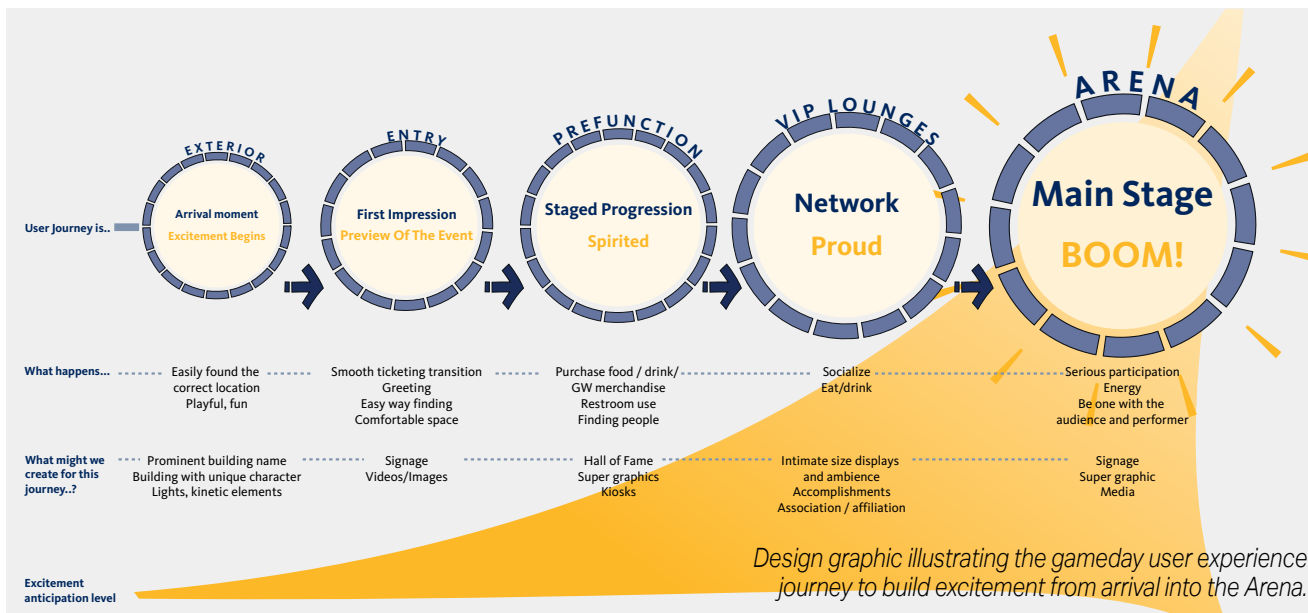

“

Suzanne's vision, expertise, and collaborative spirit have been instrumental in the remarkable success of this transformative building renovation. Her work has left an indelible mark on the department and community, serving as a testament to her exceptional talent and dedication to creating spaces that inspire and uplift those who inhabit them.”

- **Jason McGhee**, former Assistant Athletic Director, George Washington University



The Academic Center is a vital component improving the educational outcomes of student athletes.

“

Suzanne led us through a myriad of obstacles and unified the diverse opinions of the many stakeholders towards a design that excited our university community. This project design was a significant enhancement to the campus.”

- **Art Bean**, AIA, former Director of Construction Project Management, George Washington University

#### Declaration of Responsibility:

I have personal knowledge of the nominee's responsibility for the **Charles E. Smith Center**. That responsibility included: Project under direction of nominee.

- **Art Bean**, AIA, former Director of Construction Project Management, George Washington University



### 3.5 STEM Complex Phases 1, 2, & 3

The College of New Jersey, Ewing, NJ



To advance STEM education, the buildings are designed to put STEM on display and include a robotics lab; biomedical engineering teaching, research, and instrumentation spaces; an engineering design studio; a metal fabrication/assembly workshop; Computer Science research labs, and a computer cluster. Spaces are designed to foster group learning through an iterative think/model/make process.

## Realizing New Jersey's Vision to Better Prepare Graduates for STEM Careers

**Challenge:** To engage a broader spectrum of students and better prepare graduates for STEM careers, The College of New Jersey (TCNJ) needed to improve their facilities with cutting-edge spaces equipped to provide hands-on experience. However, the need far exceeded the resources provided by the state.

**Role:** With multiple departments competing for space, Suzanne orchestrated an extensive data-driven collaborative stakeholder engagement process to refine the program. **She united a diverse group around a visionary, interdisciplinary STEM Complex** encompassing over 200,000 square feet to be developed in multiple phases over seven years.

To generate campus-wide interest in STEM, Suzanne recognized the importance of a “heart” for the Complex. Thus, the Forum was born — a unique collaborative learning and research space with the lure of a café — that shapes a new

quadrangle and includes an outdoor classroom to support campus and STEM activities.

**Impact:** The former campus architect lauds Suzanne’s ability to gain consensus in prioritizing needs and wants. Throughout the extensive and well-publicized project, Suzanne directed the design while mentoring a large, diverse team of professionals. **Her leadership resulted in an innovative STEM typology that fosters multidisciplinary collaboration and synergy through shared teaching, research, and study spaces for an extensive number of courses**, while enriching each department’s identity through activity hubs, student commons, and project labs.

The provost boasts that the facilities advance TCNJ’s academic mission by giving students more opportunities to engage. The diverse spaces prioritize adaptability with flexible infrastructure and moveable furnishings,

encourage engagement with glass walls and seamless technology, and house equipment that prepares students for STEM careers.

The Complex, toured during the 2017 SCUP Mid-Atlantic conference, **raises awareness of STEM programs and deepens the 6,100+ undergraduates’ engagement with faculty research.** The Complex is improving students’ career readiness — the Engineering School cites career and graduate school preparation increased from 69% in 2016 to 82% by 2022. Today, the graduation rate is almost 100% and 25% of the engineering school graduates are women, higher than the national average. The *Wall Street Journal* ranked TCNJ in 2024 as the state’s #1 public university.

**Key Project Aspects:** Integration | Change | Discovery

**Architecture Firm of Record/Design Firm:** EYP

**Completion:** Phase 1 – 2017, Phase 2 – 2019, Phase 3 – 2020

**Role:** Senior Project Director

**Select Awards/Publications:**  
**Economic Benefit to New Jersey,**  
*Catalyst Aware*, 2017

“The College of New Jersey – STEM Complex,” *Education Snapshots*, 2019

“N.J.’s \$750 Million Investment in Colleges Starts to Pay Off,” *NJ.com*, 2017

“The College of New Jersey Opens \$76M STEM complex,” *NJ.com*, 2017



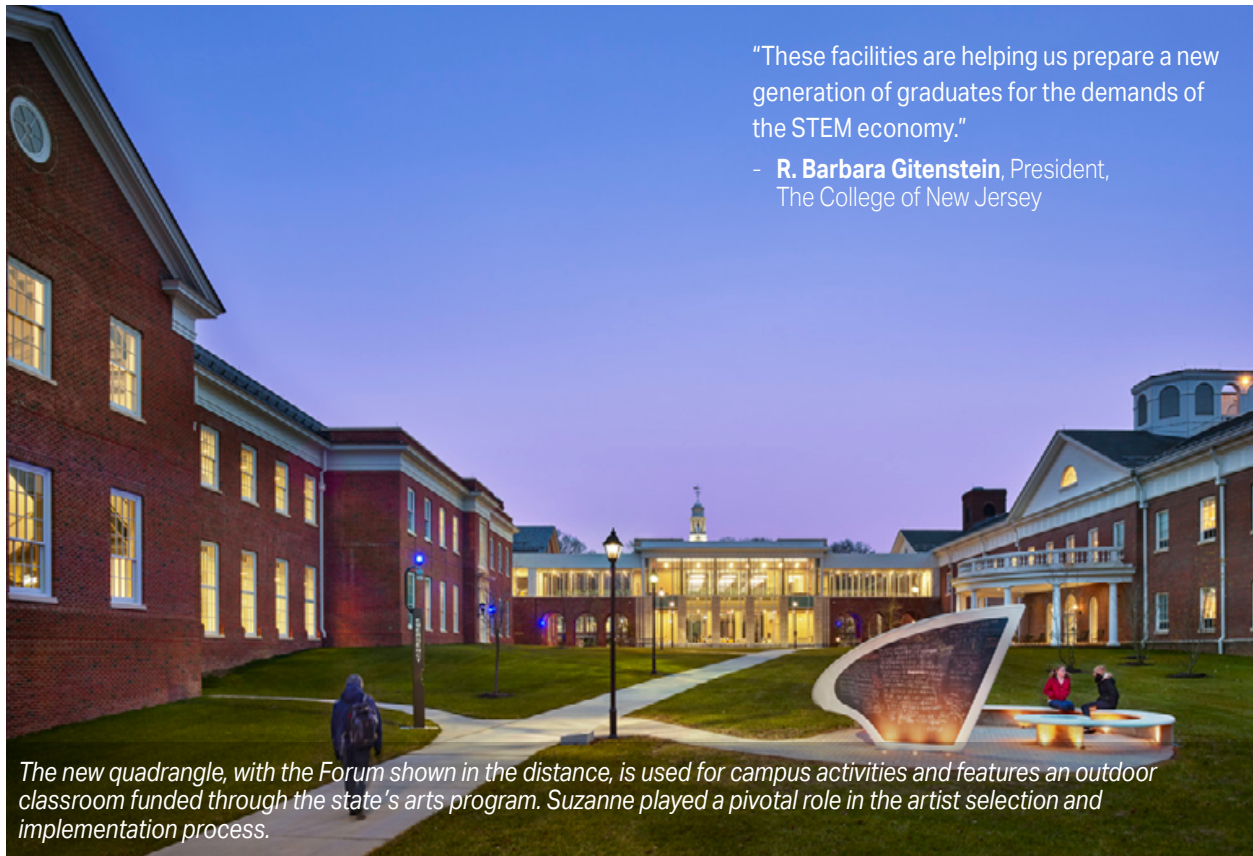

“

Suzanne was instrumental in helping TCNJ with the difficult tasks of prioritizing program needs and wants, determining construction phasing, and providing exceptional learning spaces while maintaining the budget. Suzanne's ability to manage an extensive team was paramount to the success of the projects.”

- **Lynda Rothermel**, former Campus Architect, The College of New Jersey

#### Declaration of Responsibility:

I have personal knowledge of the nominee's responsibility for the **STEM Complex Phases 1, 2, & 3**. That responsibility included: Project under direction of nominee.

- **Linda Strange**, former Assistant Campus Architect, The College of New Jersey



### 3.6 Master Plan and Phase 1 Buildings

Middlesex College, Edison, NJ



*In addition to supporting the college's students, the new Student Center, will serve as a food venue for the adjacent new Middlesex Park and Multipurpose Community Venue.*

## Rethinking Campus Planning to be a Catalyst for Broader Community Impact

**Challenge:** Middlesex College required an innovative campus plan to propel its academic mission, enhance the student experience, and align with Middlesex County's goals for economic growth and greater community connectivity for its diverse population.

**Role:** Suzanne directed and mentored a multidisciplinary team of architects, planners, engineers, and economists to create a groundbreaking plan. Eschewing traditional methods, **she employed a data-driven, economics-based approach that integrated both qualitative and quantitative insights to support decision-making.** The process included innovative needs assessment combined with collaborative stakeholder engagement. Additional research on local industry trends, student housing viability, and workforce development needs validated ambitious goals of the college and county as attainable.

To maximize the plan's impact, Suzanne identified community-focused building opportunities that would integrate facilities for learning, training, recreation, housing, and cultural activities. To drive design excellence, she developed "big moves" to upgrade the campus's visibility, increase building utilization, and enrich the facilities and landscape to support vibrant campus life for students, faculty, and visitors.

**Impact:** Under Suzanne's leadership, **the inclusive and sustainably focused plan transcended conventional planning methodologies, benefiting 10,000+ college students and 860,000+ county residents.**

In 2022, Middlesex County and the State of New Jersey announced plans to transform Middlesex College into a state-of-the-art destination, with projects in design including a multicultural venue, student center, and

athletic complex. Thanks to Suzanne's visionary planning, **Middlesex College is becoming the heart of the county, fostering community connectivity and enhancing the student experience.**

This highly publicized project has garnered attention in publications throughout the state and nation. Suzanne presented the plan to hundreds of professionals and university staff at the SCUP Annual Conference, SCUP Southern Regional Conference, SCUP Mid-Atlantic Conference, and the Campus Facilities Summit. She authored thought leadership articles on the project that reached tens of thousands in the design community.

**Key Project Aspects:** Integration | Equitable Communities | Ecosystems | Well-being

**Architecture Firm of Record/Design Firm:** AECOM

**Completed:** Ongoing

**Role:** Education Practice Leader

**Select Publications:**

"Middlesex College Campus to be Transformed Under a New Education and Infrastructure Plan," *Middlesex College*, 2022

"Development Plan Seeks to Transform Middlesex College in Edison, N.J., into a Regional Destination," *American School & University*, 2022

"Middlesex County Envisions Middlesex College a 'Multi-Faceted Destination' for Education, Sports, Arts and Entertainment," *MyCentralJersey.com*, 2022





The college's vision is to serve a diverse population of all ages by integrating facilities and programs that address every aspect of life and career. The plan includes residential options specifically aimed at supporting students, especially those facing housing insecurity.

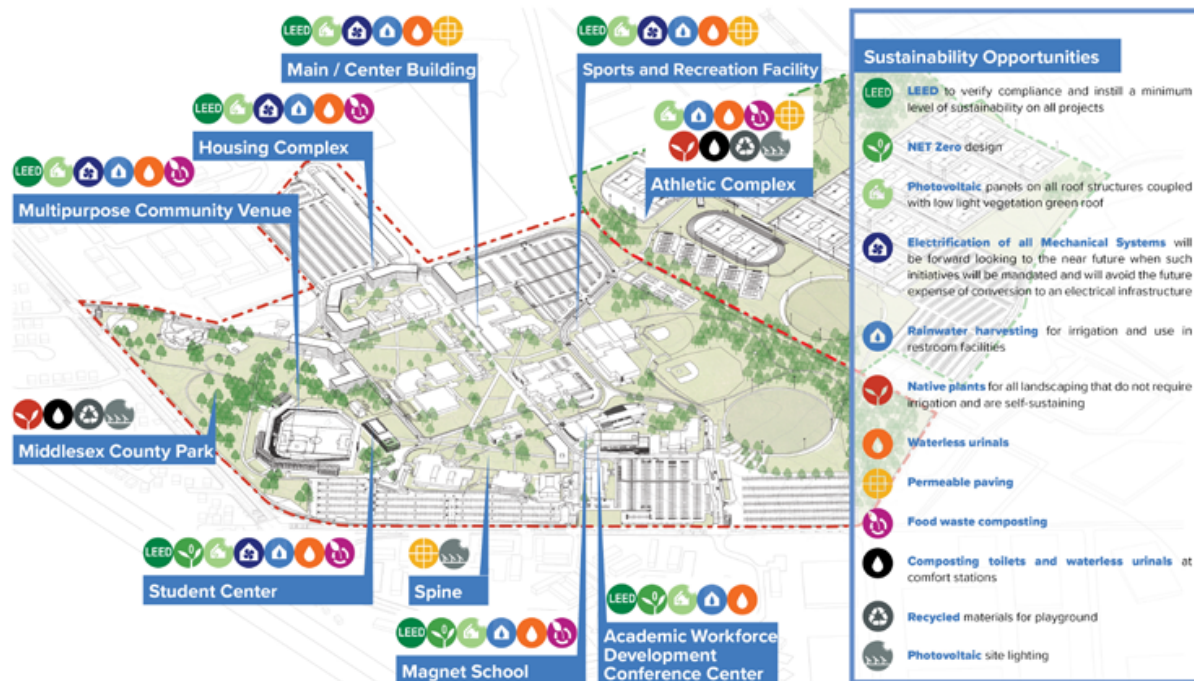

Sustainability was a crucial focus of the planning effort. The campus plan includes strategies to enhance ecosystems, conserve water, and utilize energy resources more efficiently.

“

With this extraordinary and transformative investment, Middlesex College can do even more to lean into and live up to its mission of providing access to a quality, affordable education for a diverse population, supporting student success for lifelong learning, and strengthening the economic, social, and cultural life of the community.”

- **Dr. Mark McCormick**, President, Middlesex College



The plan capitalized on the proximity to major highways. To support local workforce needs, it includes facilities for logistics training. The destination athletic complex will be a regional draw for sports competitions which can generate millions of dollars in revenue each weekend.

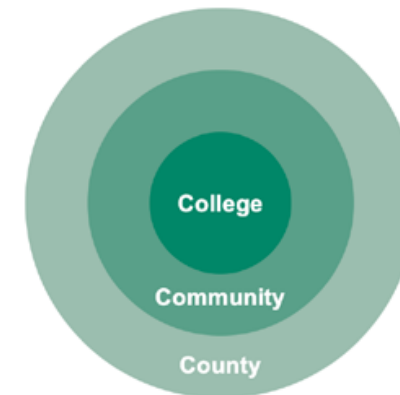

The campus plan is designed to holistically support the college, community, and county.

#### Declaration of Responsibility:

I have personal knowledge of the nominee's responsibility for the **Master Plan and Phase 1 Buildings** for Middlesex College. That responsibility included: Project under direction of nominee.

- **Linda Scherr**, Vice President, Academic Affairs, Middlesex College



### 3.7 Gibbons House

University of Virginia, Charlottesville, VA



The well-landscaped site integrates a stormwater capture network while providing a variety of exterior spaces for student activities.

## Strengthening the First-Year Experience on the University of Virginia's Grounds

**Challenge:** Student life facilities are critical for supporting academic success and Gibbons House was tasked to be the benchmark for future residence halls. To strengthen the first-year experience, the design had to exhibit a refined architectural standard in the backdrop of UVA's Academical Village, a UNESCO World Heritage Site, plus incorporate the Housing & Residence Life office.

**Role:** To enhance well-being in this typology, Suzanne spearheaded innovative concepts that established resident advisor communities of 20-26 students per floor. Dedicated spaces on each of the five floors foster community and a sense of belonging for 219 residents.

Faced with the challenge of integrating complex infrastructure and stormwater requirements on a steep site, Suzanne directed charrettes with facilities staff, utility officials, and the fire chief

to swiftly address issues and ensure universal accessibility.

**Mentoring her team, Suzanne oversaw material selection and detailing to meet UVA's standards of refined quality.**

Consistently advocating for well-being and sustainability, she conducted studies on windows, light penetration, and sun exposure angles, resulting in excellent interior light and stunning views of the Blue Ridge Mountains and Monticello.

**Impact:** Strategically situated along a main road, the Housing & Residence Life office is easily accessible for the 4,000+ first-year students living on UVA's Grounds. Named to honor a formerly enslaved couple associated with the university, **Gibbons House has been commended by staff for raising the standard of first-year residence life at UVA.**

Suzanne's commitment to design excellence resulted in elegant brick detailing, expansive sun-screened windows, and numerous collaborative spaces and landscape amenities. **Her leadership in orchestrating the site plan created ample passive and active outdoor areas that enhance the student experience and ensure universal accessibility.** Driven by her unwavering advocacy for sustainability, the building achieved LEED Gold certification. Celebrated by thousands of alumni, students, and fans each year, former president Teresa Sullivan praised Suzanne's contributions for making the building a point of pride for the university.

**Key Project Aspects:** Integration | Equitable Communities | Well-being | Water

**Architecture Firm of Record/Design Firm:** EYP

**Completed:** 2015

**Role:** Senior Project Director

**Select Publications:**

"New U.Va. Residence Hall, Gibbons House, Named for Former Slave Couple," *UVA Today*, 2015

"New UVA Residence Hall, Gibbons House, Named for Former Slave Couple," *Augusta Free Press*, 2015

"U.Va. Naming New Dorm After Once-Enslaved Couple," *WSLS Channel 10 News*, 2015

"Gibbons House Dedication Memorializes Former Slaves, Successful Free Lives," *UVA Today*, 2015





*Throughout Gibbons House, thoughtfully designed spaces enhance student life and the academic experience. Each floor features community areas that foster a sense of belonging and comfort for students.*

“

Suzanne Klein played an important leadership role in the design of Gibbons House. Gibbons House is viewed by thousands of alumni, students, and fans every year. It is such an attractive building and a point of pride for the University. Gibbons House is a coveted residence hall for first-year students. We are proud of the impact Ms. Klein had in the development of such a significant and important building.”

- **Teresa A. Sullivan**, President Emerita and University Professor, University of Virginia



*The site plan, with Gibbons House shown in orange, illustrates the complexity of the site constraints and integrates ample landscaping and a variety of exterior spaces.*

“

Suzanne provided exceptional leadership in the planning, programming, and design of Gibbons House. The steeply sloping site, its complex existing utility infrastructure and regional stormwater management requirements were met with intelligence, experience, and responsiveness. UVA was a typical college/university client with multiple goals/interests, which Suzanne managed with remarkable skill and collaboration to very successful result.”

- **David Neuman, FAIA**, former University Architect, The University of Virginia

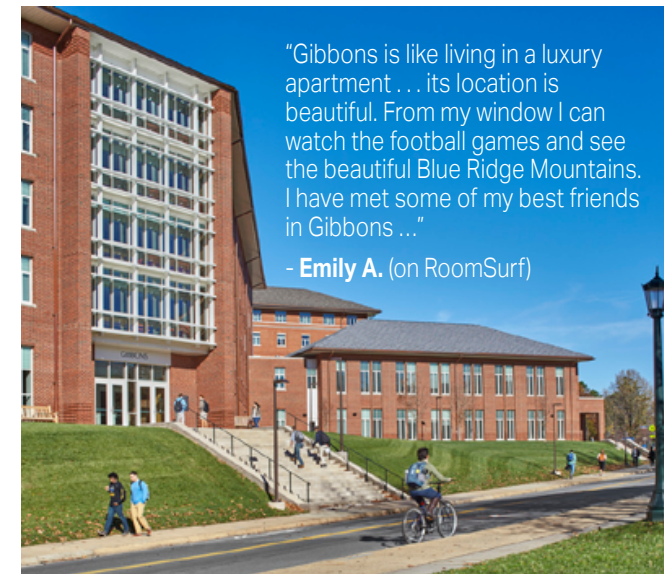

“Gibbons is like living in a luxury apartment ... its location is beautiful. From my window I can watch the football games and see the beautiful Blue Ridge Mountains. I have met some of my best friends in Gibbons ...”

- **Emily A.** (on RoomSurf)

*Gibbons House, prominently located along Alderman Road, showcases expansive fenestration and brick detailing. The two-story Housing & Residence Life office on the right is ideally located for student access.*

#### Declaration of Responsibility:

I have personal knowledge of the nominee's responsibility for the **Gibbons House** project. That responsibility included: Project under direction of nominee.

- **Kit Meyer**, Project Director, University of Virginia



### 3.8 Gore Hall

University of Delaware, Newark, DE



Despite being built decades after the original historic structures, Gore Hall fits into Delaware's vernacular while providing its own distinctive character. The four columns on the portico create a prominent presence and Gore Hall has become the most showcased building on the campus.

## Creating an Icon that Boldly Transforms the Student and Campus Experience

**Challenge:** The goal was formidable: alumnus Robert Gore wanted to improve the learning experience for students of all majors with an innovative classroom building typology in the design vernacular of original campus architect, Charles Klauder, on the historic main quadrangle's remaining site.

**Role:** Incorporating design principles that advance pedagogical models for interdisciplinary learning, **Suzanne spearheaded the interior planning for this academic typology while meticulously crafting the three-story building's massing and details.** Rather than copy existing structures, Suzanne extensively studied the context to align proportions and materials to reflect the university's language while advancing the campus's architectural legacy. Mentoring a junior architectural team, Suzanne fashioned custom details for every part of the building – including windows, doors, and the

four 35-foot-high turned concrete columns at the main quadrangle entry.

**Impact:** As the university's first non-departmentally scheduled classroom building, Gore Hall advances innovative pedagogies and promotes interdisciplinary and collaborative learning with a diverse variety of flexible spaces that seat 1,225 with state-of-the-art technologies and exceptional fenestration in each classroom.

For 25 years, **Gore Hall has elevated the academic experience for 24,000+ students and 1,300+ faculty annually.** The registrar confirms it remains the most scheduled campus building with 200+ courses per semester. Students from all majors take at least one class in Gore Hall each semester, with 125,000+ students having benefited from this building to date.

Gore immediately became a landmark featured

on the website and campus tours. President David P. Roselle described **Gore Hall as a magnificent landmark classroom building and the university's living room.** Gore Hall inspired the design of the transformed Du Pont Hall College of Engineering, directly across the campus green.

Showcasing innovative academic spaces to hundreds of planning professionals, SCUP's Mid-Atlantic Conference was held twice in Gore Hall. **Suzanne's work on Gore Hall became a career-defining building that ignited her passion for collegiate design, setting the foundation for her future projects.**

**Key Project Aspects:** Integration | Equitable Communities | Well-being

#### Architecture Firm of Record/Design

**Firm:** Allan Greenberg, Architect

**Completed:** 1998

**Role:** Project Architect

#### Select Awards/Publications:

**Delaware Contractors Association, Excellence in Construction Award, 1999**

University of Delaware's Gore Hall, *Design Cost Data*, 1999

"Gore Hall, New Classroom Building, a 'Magnificent Landmark' for the Mall," *University of Delaware Messenger*, 1998



*With the documented impact of sunlight on learning, incorporating light into each classroom was paramount. The south elevation showcases the building's extensive fenestration and views to the campus's main green.*

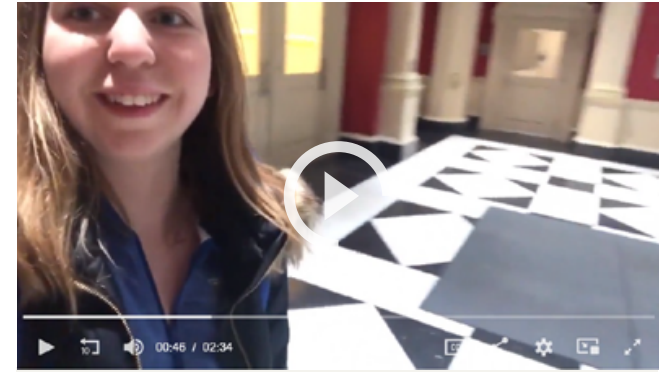

**Lily Wolfe**, 2019 graduate, shares why Gore Hall is her favorite building on campus.

[Click to hear more about Gore Hall](#) ►

“

I had the privilege of being one of the first professors to teach in Gore Hall. Its beauty was inspiring to me and to my students, from the soaring atrium to the light, airy classrooms equipped with cutting-edge technology. It has made a wonderful contribution to the teaching environment at the University of Delaware.

- **Joan DelFattore**, Professor of English, Emeritus, University of Delaware



*A three-story atrium, located at the building's cross axes, is a campus meeting point and venue for special events.*



*Suzanne oversaw the detailing of every aspect of the building including inspecting the custom light fixtures which flank the main entrances.*

#### **Declaration of Responsibility:**

I have personal knowledge of the nominee's responsibility for **Gore Hall**. That responsibility included: Largely responsible for development of design, detailing, and construction administration.

- **Allan Greenberg**, Principal in Charge, Allan Greenberg, Architect



### 3.9 The Humanities Building Rice University, Houston, TX



Treetop view with Pitman Tower on the left.

## Extending a Legacy to Advance the Humanities Community

**Challenge:** Rice University aimed to create a flagship building for the School of Humanities near the main quadrangle. The design needed to be both contextual and innovative, harmonizing with the Neo-Byzantine style while establishing its own legacy and enhancing the prominence of the humanities.

**Role:** Through innovative program development for this academic typology, **Suzanne designed a range of classrooms that enhance collaborative learning.** She also incorporated dedicated and shared spaces that cultivate a strong sense of community for faculty in the Philosophy, History, and Religious Studies departments, as well as institutes like the Study of Women and Gender.

The prominent site was not evident from the quadrangle, so Suzanne brought life to the schematic concept for an 80-foot-high tower – a symbolic centerpiece for the School. While

mentoring the architectural team, she directed extensive coordination with masons, cast stone fabricators, and tile manufacturers, overseeing the detailing and construction administration for the building, including its intricate façades and tile roofs.

**Impact:** Suzanne's passion for collegiate design and attention to detail generated a tour de force of pattern, texture, and campus-specific iconography that boldly **extends the campus's architectural legacy in an iconic structure that builds community, advances academic programs, and encourages belonging.**

The former dean praised the building as the centerpiece of a new beginning in humanistic study for 8,200+ students and 2,100+ faculty and staff at Rice. As noted in Rice's alumni magazine, *Sallyport*, the building unites scholars who study and teach the humanities and creates greater collaboration, enhancing

interdisciplinary study – hallmarks of a Rice education.

The Humanities Building has been a powerful design influence for future Rice projects, such as McNair Hall and Brockman Hall for the Opera. **Celebrated nationally in numerous publications, this award-winning building has been a powerful design influence for one of Suzanne's subsequent projects** – the D'Angelo Center at St. John's University in New York.

**Key Project Aspects:** Integration | Equitable Communities | Ecosystems

**Architecture Firm of Record/Design Firm:** Allan Greenberg, Architect – Design Architect & Architect-of-Record; Morris Architects – local consultant

**Completed:** 2000

**Role:** Project Architect

**Select Awards/Publications:**  
**2002 Cast Stone Institute, Design Excellence**

**2002 Masonry Contractors Association of America, International Excellence in Masonry**

"Strangely Familiar (Featuring The Humanities Building, Rice University)," *Architectural Record*, July 2003

"Stalwart Classicist Allan Greenberg Takes on the Fantastic, Neo-Byzantine Idiom of Ralph Adams Cram," *Architect Magazine*, May 2001





*The building's Z-shape forms a courtyard shaded by live oaks. Named for donors Lee and Joe Jamail, it is a contemplative place for students and faculty to gather, collaborate, and hold special events.*

“

Suzanne Klein provided great vision for the campus and stretched our imagination during the planning. It was the first addition to the academic quad in over 25 years, so the siting of the building, design, and detailing were critical to the Board of Governors. The Humanities Building enriched the Rice campus, upheld the university's architectural consistency, and elevated the prominence of the humanities programs.”

- **Paul Sanders, AIA**, former Project Manager, Rice University

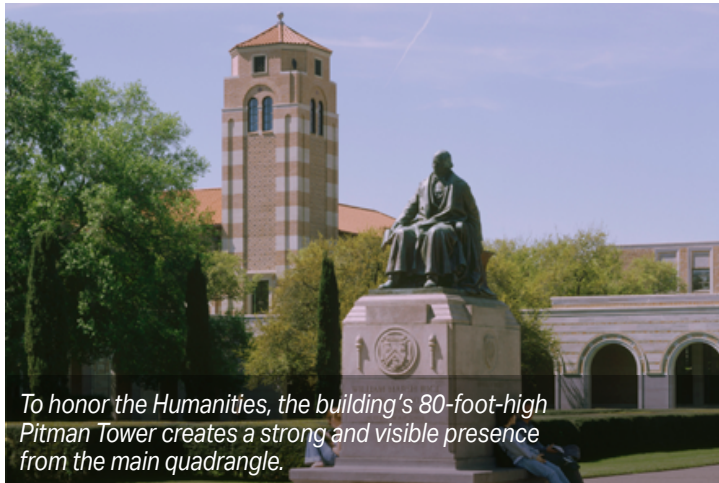

*To honor the Humanities, the building's 80-foot-high Pitman Tower creates a strong and visible presence from the main quadrangle.*



*The building's intricate juxtaposition of materials extends Ralph Adams Cram's legacy while creating its own distinct presence with a sallyport, dramatic tower, and allées of trees.*

#### **Declaration of Responsibility:**

I have personal knowledge of the nominee's responsibility for **The Humanities Building**. That responsibility included: Largely responsible for development of design, detailing, and construction administration.

- **Allan Greenberg**, Principal in Charge, Allan Greenberg, Architect



## 3.10 Mentoring Emerging Leaders



Suzanne's architectural team cartooning the construction documents set for the Integrated Science Center at the College of William & Mary – a significant feat as the submission was over 200 pages.



Suzanne and her core team at The College of New Jersey's STEM Complex Phase 1 dedication. Suzanne led the team over seven years and mentored an extensive number of architects and engineers during the multi-phase project.

## Inspiring and Fostering Next Generation Talent

**Challenge:** Becoming an architect is challenging, and mentorship is crucial for grasping design and technical requirements. Developing expertise in collegiate building typologies requires years of experience to create innovative solutions and earn clients' trust. Enhancing diversity is vital to ensuring that tomorrow's buildings are inclusive and responsive to societal challenges.

**Role:** Over 35 years, Suzanne has actively nurtured and hired staff as a dedicated mentor. She is committed to advancing the collegiate design practice by sharing her expertise, supporting her teams' aspirations, and nurturing their career development as they evolve into leaders. Notably, she places an emphasis on advancing women in the profession, advocating for their empowerment and fostering greater gender equality.

**Impact:** Suzanne's leadership and expertise have profoundly shaped the careers of hundreds of staff, many of whom have become leaders in the profession. Today, her mentees are making an impact in over 20 states and six countries.

On every project, Suzanne actively mentors her team, empowering them to pursue design excellence while advancing the AIA Framework for Design Excellence. She organized work sessions for the William & Mary Integrated Science Center team, guiding them through the necessary details and documentation for each submission and helping them understand collegiate clients' design standards.

**Suzanne mentors staff on the distinct programmatic and technical needs of collegiate projects,** from labs to residence halls. She includes them in client meetings and site visits to broaden their design experience,

guiding them to refine their skills and assume greater responsibilities.

Many of Suzanne's mentees seek her advice, particularly women who feel undervalued in their roles. **Suzanne coaches them to recognize their goals and strengths, equipping them to effectively evaluate their worth.** With her guidance, these women have successfully negotiated higher salaries and advanced their positions within their firms.

As a dynamic speaker, Suzanne inspires emerging professionals and architecture students alike. At the University of Maryland's Careers in Architecture event, she engaged hundreds of attendees as a panelist. During an International Women's Day event, she shared invaluable insights, empowering emerging talent to navigate their professional journeys with confidence.

 IWD 2024 Panel Discussion  
**#InvestInWomen**  
Wednesday, March 20  
12 p.m.  
AECOM Arlington  
Rosslyn Room, 8th Floor  
Will also be streamed on Microsoft Teams

Please join us for this discussion in which women leaders at AECOM discuss their experiences and the path toward improving gender equality in the workplace and beyond.

**Panelists**

 <b>Kim Bright</b> Senior Associate, Project Manager	 <b>Ursula Finley</b> Principal, Director of Interior Design	 <b>Jeannie Gasper</b> Principal, Project Management	 <b>Rosa Gwinn</b> Global Initiative Leader, PFAS Technical	 <b>Suzanne Klein</b> East Region Education Market Leader
--	---	---	--	--



This presentation reached hundreds of staff, in-person and virtually.

**Architecture Firm of Record/Design Firm:** AECOM, EYP, KlingStubbins, Gensler, Allan Greenberg Architect, Hartman-Cox, Oudens + Knoop, Garrison Associates

**Completed:** Ongoing

**Role:** Principal in Charge, Education Practice Leader, Studio Director, Project Director, Project Architect, Job Captain



**Michelle Sanders**, AIA, Associate Principal and Medical Planner, ZGF, Washington, DC. "Suzanne is a woman who is full of energy and positivity. She instills trust in every client that gets to work with her and **encourages her teams to be their very best throughout the entire project.** Being a woman in this industry is not easy, but seeing Suzanne excel in her career gives me inspiration and hope for the future."

*Project involvement: Integrated Science Center Phase 3, College of William & Mary*



**Dana Miarmi**, Senior Vice President, JLL, New York, NY. "Suzanne is a leader and has always led by example. **She has a keen talent for getting the best results from her team and helps them become better professionals.** She recognizes that every member of her team has something valuable to share, and she helps them find their voice and tap into their potential. Having Suzanne as a female mentor early in my career paved a solid path to success for me."

*Project involvement: The Mason Inn, George Mason University*



**Sara Jimenez**, Int'l Assoc AIA, Project Manager, Arquitectonica, Miami, FL. "I saw Suzanne connect with clients to understand their needs and guide them to make the decisions that make the best spaces for their educational facilities. **Suzanne also made sure to involve the team in the process, listening and mentoring while keeping us focused on the end goal.** Thanks to Suzanne for inspiring me to be a better architect."

*Project involvement: Lifelong Learning Center, University of Miami*



**Ryan Knox**, Project Executive, Clark Construction, Fairfax, VA. "Suzanne's expertise and leadership ensured the vision was delivered and the project was a resounding success. **Suzanne taught me many valuable insights that will benefit my career.** Suzanne built team consensus and translated multi-stakeholder needs into actionable decisions."

*Project involvement: E.A. Fernandez IDEA Factory, University of Maryland (Exhibit 3.3)*



**Ryan Mullen**, Project Architect, HDR, Tampa, FL. "Suzanne Klein mentored me as my project director for numerous projects from 2011-2017 during my transition from an architectural coordinator to that of a job captain in the lead up to obtaining my architecture license in 2018. **Her patience and leadership combined with a profound dedication to the profession helped to make me the successful architect I am today.**"

*Project involvement: Gibbons House, University of Virginia (Exhibit 3.7)*



**Jeannie Gasper**, AIA, LEED AP, Project Manager, AECOM, Arlington, VA. "Suzanne Klein has been instrumental in building my resume as a project manager. **Her knowledge and enthusiasm is highly valued on how to win work and to best serve our clients.** She offers leadership in guiding me through dealing with university clients thus making me a trusted partner in solving their problems."

*Project involvement: Multi-Building Renovation, Clemson University*



**Anitha Deshamudre**, Senior Designer, KCCT Architecture, Washington, DC. "Suzanne is such a positive influence for younger design professionals. **She has been inspiring to learn from as a young designer striving to work up the project management ladder.** Her trust in my skillsets allowed me to develop an appreciation for construction administration and working with the site team. Her broad range of experience and love for design will continue to pave the path for other young women."

*Project involvement: STEM Complex Phases 1, 2, & 3, The College of New Jersey (Exhibit 3.5)*



**Rebecca Ross**, AIA, Senior Project Manager, Page, Atlanta, GA. "Suzanne has been an exceptional mentor providing me with an example of how to grow throughout my career. **I admire her ability to navigate complex projects as well as share her expertise in higher education to guide the success of her team.** She brings value to each project and team she works with – while paving the path for future generations to learn and collaborate with her."

*Project involvement: Life Sciences & Engineering Building, George Mason University*

“

Suzanne Klein is an architect who educates. Her mentorship, especially of women, has shaped a new generation of professionals dedicated to holistic solutions that cultivate campus legacies, advance learning strategies, and enhance university life."

– **Gerald Briggs, FAIA, AECOM, Principal and Vice President**

#### Declaration of Responsibility:

I have personal knowledge that the nominee is responsible for the achievements noted in this exhibit.

– **Kip Ellis, AIA, Principal, Goody Clancy**



**DENISE M. BERGER, FAIA, FRICS**

Chief Strategy & Innovation Officer  
AECOM, East Region  
New York, NY

*Professional Colleague*

**SUSAN B. MCCLYMONDS, FAIA, CSI, CCS, SCIP, NCARB**

Self-Employed  
Architectural Specifications and Construction Contracts Consulting  
Amsterdam, NY

*Professional Colleague*

**ROBIN PUTTOCK, AIA, LEED AP, WELL AP**

Assistant Professor  
College of Architecture and Construction Management  
Kennesaw State University  
Marietta, GA

*Professional and Academic Colleague*

**BRIAN TUCKER, AIA, LEED AP**

Senior Planner, Principal  
Page  
Washington, DC

*Mentee*

**HEATHER TAYLOR, AIA, LEED AP**

Campus Planner & Architect  
Phillips Exeter Academy  
Exeter, NH

*Professional Colleague*

**MARK MCCORMICK, ED.D, J.D.**

President  
Middlesex College  
Edison, NJ

*Client*

**DAVID BUERGLER, RA**

Owner  
David Buerger, Architect  
San Francisco, CA

*Mentor*

**DAVID HARESIGN, FAIA**

Principal  
Bonstra | Haresign Architects  
Washington, DC

*Professional Colleague*

**ERIC DINGES, AIA, NCARB, CLGB, LEED GREEN ASSOCIATE**

Chief Executive Officer  
PBK  
Houston, TX

*Former Supervisor*

**ANN BAROLAK, AIA, MBA**

Vice President  
STV  
Philadelphia, PA

*Professional Colleague*